

 **Profelmnet**  
THE POWER TO MOVE

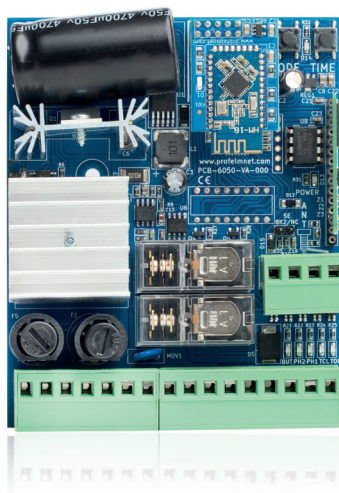

**5650**  
**USER**  
**MANUAL**

**EASYTECH PRO**





## SERIES 56

**Series 56** is a complete series of PROFELMNET control boards, with integrated Bluetooth technology. Compatible with Profelmnet Easy Tech PRO application that is available in IOS and Android. The installer is able to access and adjust all the functions of the control board through the smartphone, tablet or laptop.

The models of series 56 are :

- 5633** control board for sliding and swing gate, roller shutter, barrier 230VAC
- 5650** control board for sliding and swing gate, barrier, pergolas 24V
- 5614** control board for double motors 230VAC
- 5651** control board for double motors 24V

### CE Declaration of Conformity

The manufacturer **L. PSARROS & SIA OE** declares that the products **5650, 5633, 5614, 5651** are according to European Directives requirements of **RADIO EQUIPMENT DIRECTIVE (RED) 2014/53/EU** and **ELECTROMAGNETIC COMPATIBILITY EMC 2004/108/EC**

**Profelmnet**  
**Λ. ΨΑΡΡΟΣ ΚΑΙ ΣΙΑ Ο.Ε.**  
ΕΙΣΑΓΩΓΕΣ – ΚΑΤΕΣΤ. ΗΛΕΚΤ. ΥΛΙΚΟΥ  
ΑΓ. ΔΗΜΗΤΡΙΟΥ 286Α Τ.Κ. 11342 ΑΓ. ΔΗΜΗΤΡΙΟΥ  
ΑΦΜ: 800845047 ΔΟΥ ΑΓ. ΔΗΜΗΤΡΙΟΥ  
ΑΡ. ΓΕΜΗ: 142769401000  
ΤΗΛ.: 210 9650244 / FAX: 210 9623264

**Labros Psarros**  
Electronics Engineer  
Technical Director

## Warning for the installer

1. **ATTENTION!** To ensure the safety of people, it is important that you read all the following instructions. Incorrect installation or incorrect use of the product could cause serious harm to people
2. Carefully read the instructions before beginning to install the product
3. This product was designed and built strictly for the use indicated in this documentation. Any other use, not expressly indicated here, could compromise the good condition/operation of the product and/or be a source of danger
4. Store these instructions for future reference
5. Before attempting any job on the system, cut out electrical power
6. Make sure that a differential switch with threshold of 0.03 A is fitted upstream of the system
7. Do not in any way modify the components of the automated system
8. Do not allow children or adults to stay near the product while it is operating
9. Keep remote controls or other pulse generators away from children, to prevent the automated system from being activated involuntarily
10. The user must not attempt any kind of repair or direct action whatever and contact qualified personnel only
11. Profelmnet as a manufacturer reserves the right to make changes to the product without notice
12. Anything not expressly specified in these instructions is not permitted
13. It is essential to use a T1.25 A fuse on the primary coil of the power transformer.
14. It is mandatory to ground the metallic parts of the motor. Connect the motor grounds to the power supply ground.

# 5650

Wiring diagram for automation of sliding and swing gate, barrier, pergola 24VDC

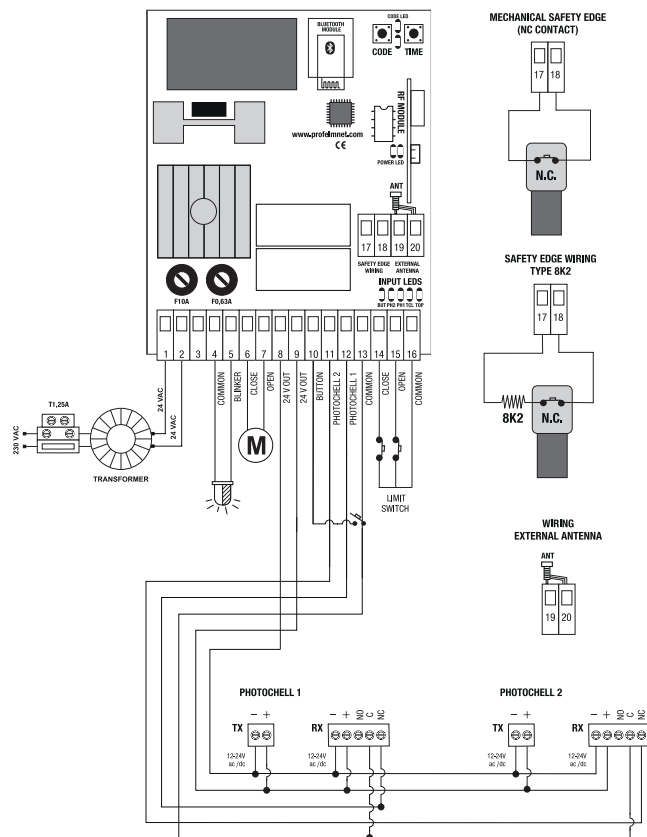

## TECHNICAL CHARACTERISTICS

Power Supply	24VAC/DC
Motor Power	200W in total
Box Dimensions	9,5cm X 4,5cm X 13cm
Board Dimensions	7,5cm X 3cm X 10cm
Trasformer Primary Side Fuse 230VAC	T1,25A
Power Supply Fuse 24VAC/DC	F10A
Photocell Fuse	F0,63A
Flash Power Supply	24VDC
Photocells Power Supply	24VAC/DC
Board Memory	removable up to 300 remotes
Temperature	-20°C + 60°C

## ELECTRICAL CONNECTIONS

1	+24VAC	11+13	Contact Photocell 2 NC
2	-24VAC	12+13	Contact Photocell 1 NC
3	Not Used	13	Common
4-5	Light 24VDC	14+16	Close terminal Switch - N.C
6	Close Motor	15+16	Open Terminal Switch - N.C
7	Open Motor	16	Common Terminal Switch
8	24VOut	17+18	Safety Edge NC /8K2
9	24VOut	19	External Antenna 433,92MHz
10+13	Contact Button - N.O	20	Shield Antenna 433,92MHz



ACTIVATE INTERNET AND BLUETOOTH  OF YOUR DEVICE  
DOWNLOAD THE PROFELMNET EASYTECH PRO APPLICATION

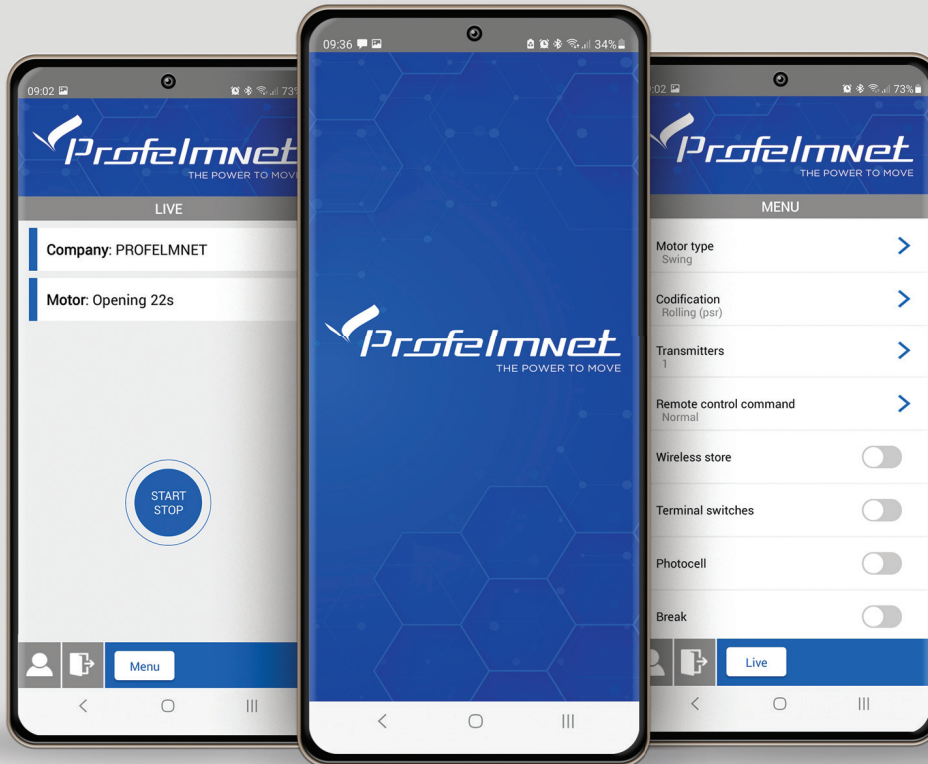

SETTINGS - CONFIGURATION - 5650



ProfelmNet  
EasyTech Pro



## REGISTER

FOLLOW THE STEPS TO REGISTER

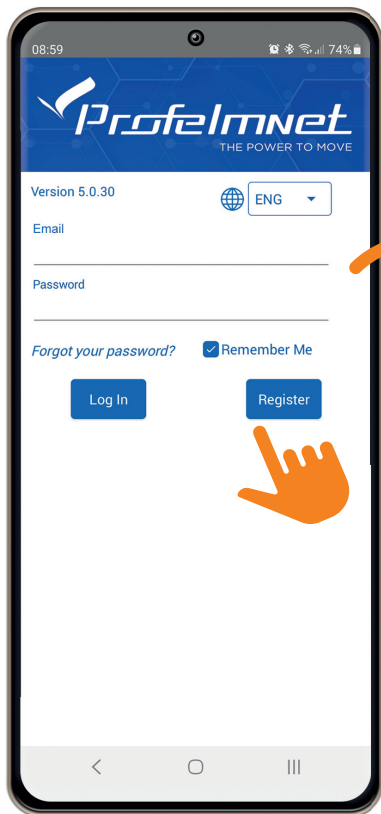

08:59

Profelmnet  
THE POWER TO MOVE

Version 5.0.30

ENG

Email

Password

[Forgot your password?](#) ☒ Remember Me

[Log In](#) [Register](#)

An orange arrow points from the Register button to the next screen.

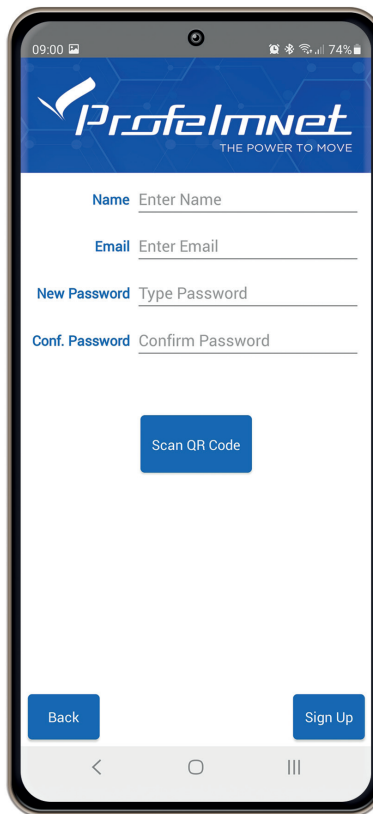

09:00

Profelmnet  
THE POWER TO MOVE

Name

Email

New Password

Conf. Password

[Scan QR Code](#)

[Back](#) [Sign Up](#)

- 1 Choose the language
- 2 Press Register & fill in your personal data
- 3 Scan QR code. Find the QR code on the board & scan it
- 4 Press sign up to finish

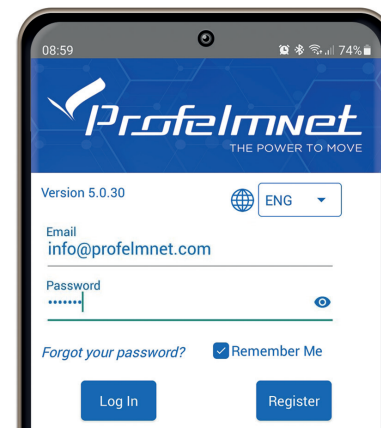

08:59

Profelmnet  
THE POWER TO MOVE

Version 5.0.30

ENG

Email  
info@profelmnet.com

Password  
.....

[Forgot your password?](#) ☒ Remember Me

[Log In](#) [Register](#)

## CONNECTION with the board

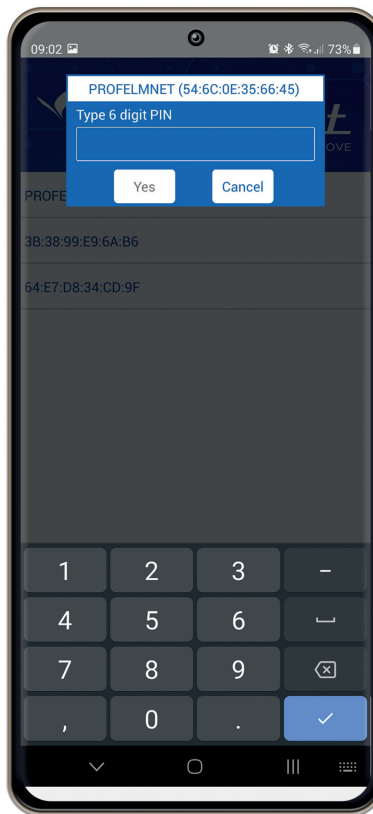
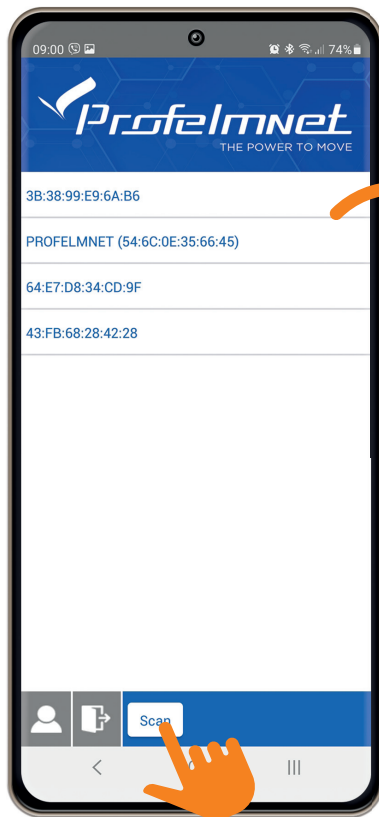

- 1 Press scan to find the PROFELMNET device
- 2 Choose the PROFELMNET device
- 3 Type the 6 Digit PIN

During the first connection, type 000000 PIN and then type your personal 6-digit PIN.



The PIN code is your personal security number. Without this PIN code, you can not access the board. Avoid using simple easy PIN codes (i.e 1 1 1 1 1 1)

## LIVE SCREEN

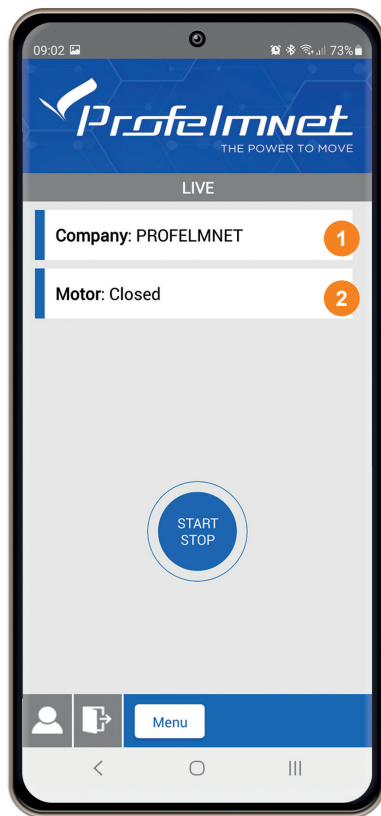

- 1 Company:  
Board Supplier
- 2 Motor:  
Installation Info

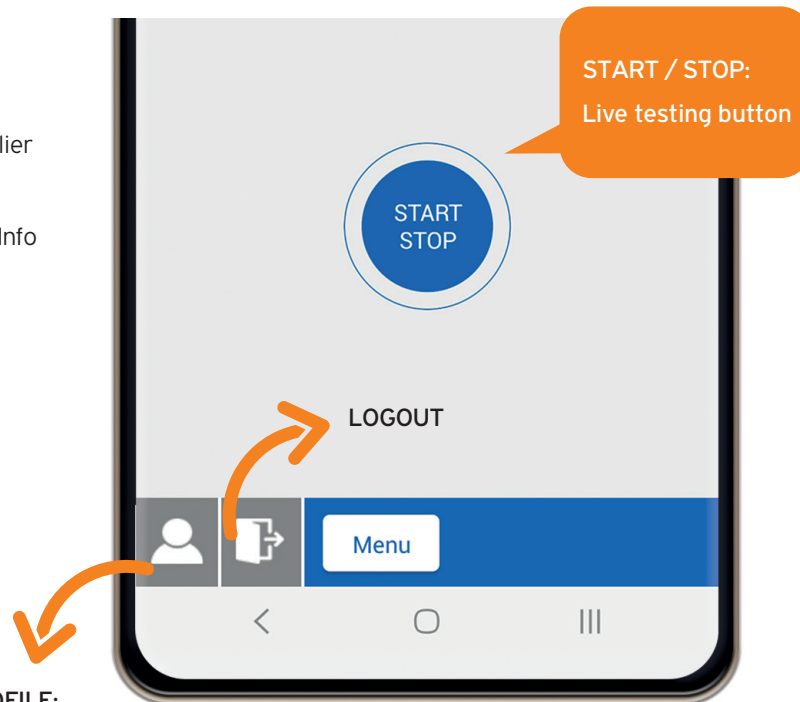

**USER PROFILE:**  
Edit your personal data

## SWITCH LIVE SCREEN TO MENU SCREEN

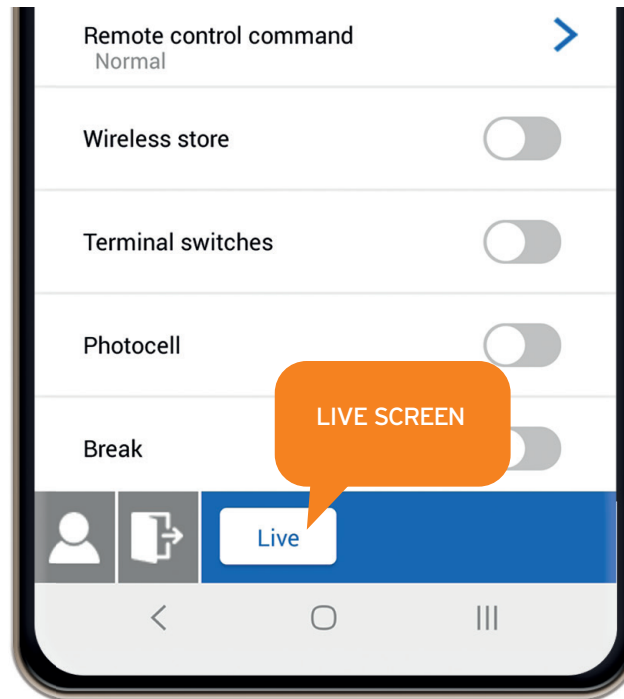
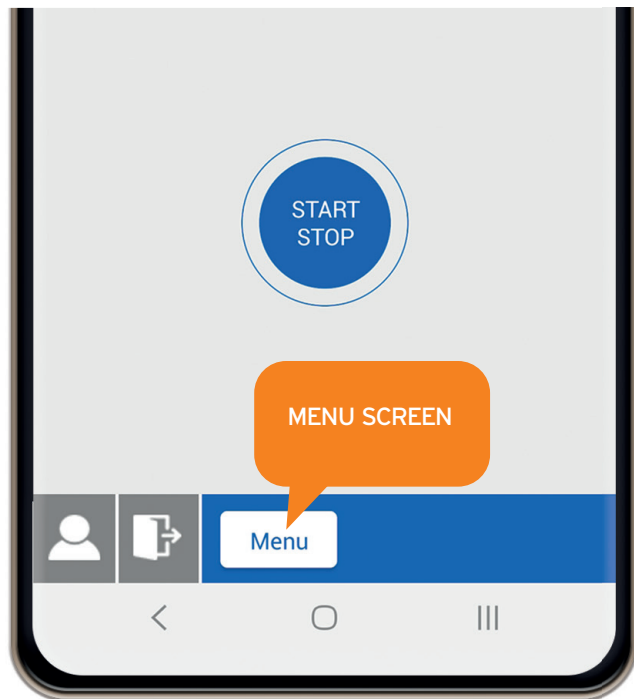

## MENU: Motor Type

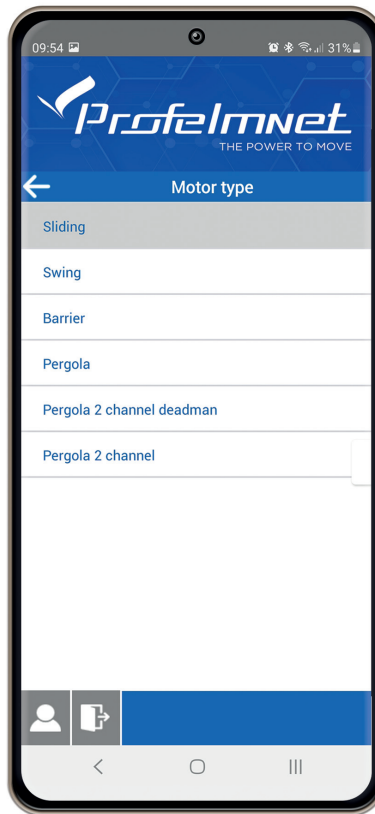
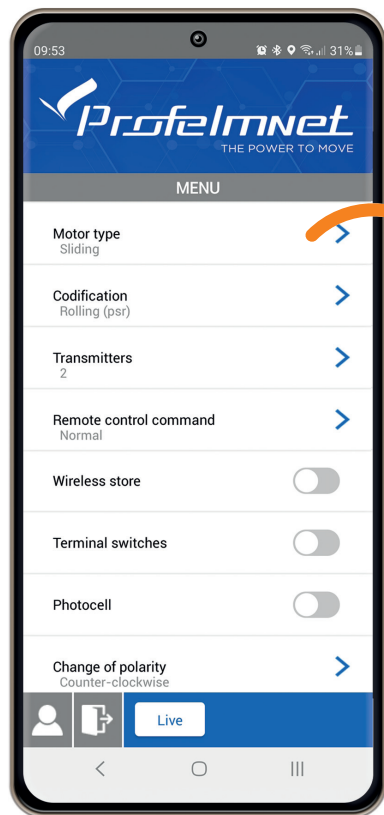

Select based on the installation

### SELECTION CONFIRMATION

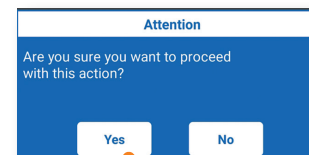

## MENU: Codification

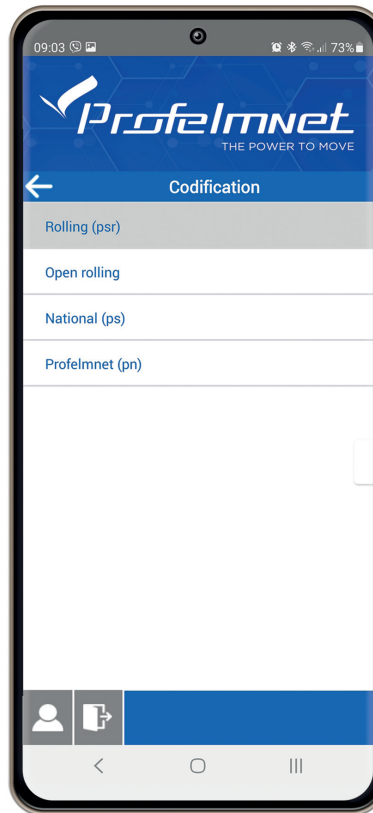
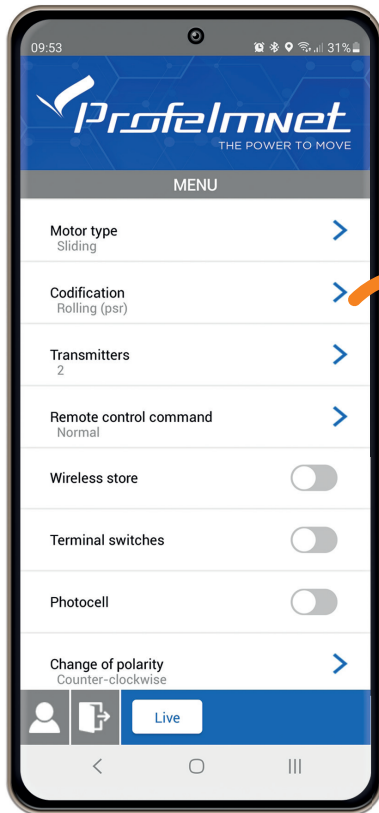

Codification: Select based on the installation's transmitters

## MENU: Transmitters

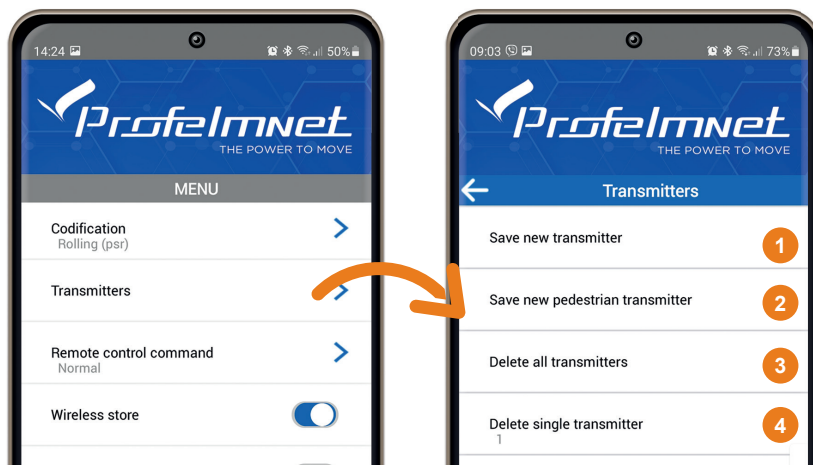

FOR SLIDING - SWING - BARRIER - PERGOLA

- 1 **Save new transmitter:**  
Press the transmitter button you want to save
- 2 **Save new pedestrian transmitter:**  
Press the transmitter button you want to save as pedestrian
- 3 **Delete all transmitters:**  
YES/NO
- 4 **Delete single transmitter:**  
Choose the number of transmitter to DELETE.

**Adding a new remote remotely:** The motor is fully closed or open. Press a working remote button (already in memory) to start the motor working and hold it pressed until the motor stops. When it stops, leave it and press the new remote button immediately. The new remote is saved. Repeat steps to program more remotes remotely. When the memory is full (300 remotes) you cannot add more new remotes

### TIP

**COMPATIBLE REMOTES:** Based on the model you have

**PS:** Fixed Code 433,92MHz. Compatible remotes are fixed code 433,92MHz

**PSR/PN:** Rolling Unique Code 433,92MHz. Compatible Remotes with same Unique Rolling Code.

**WHERE YOU FIND THE UNIQUE ROLLING CODE OF THE BOARD:** On the control board, there is a white productions sticker by Profelmnet. You will find the Unique Rolling Code, with which you search for compatible controls.

### TIP

**ADDING A NEW TRANSMITTER WITH THE CONTROL BOARD CODE BUTTON:** Press the CODE button and the RED indication light goes ON. Leave it and during the next 3 seconds, press the desired transmitter channel button until the RED indication light blinks and goes OFF. The new transmitter is saved. Follow the same procedure to program more (up to 300 remotes) new remotes.



## MENU: Transmitters

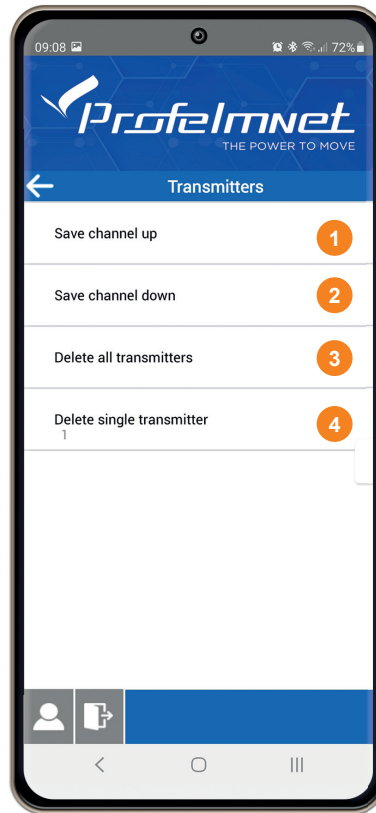
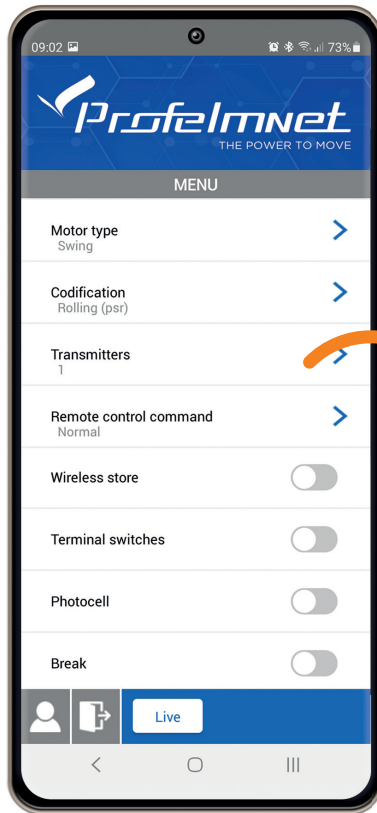

- 1 Save channels up:**  
Press the transmitter button you want to save for UP direction
- 2 Save channel down:**  
Press the transmitter button you want to save for DOWN direction
- 3 Delete all transmitters: YES/NO**
- 4 Delete single transmitter:**  
Choose the number of transmitter to DELETE.

### SELECTION CONFIRMATION

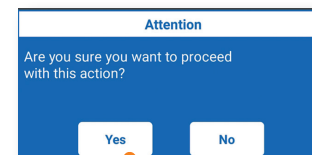

## MENU: Remote control Command

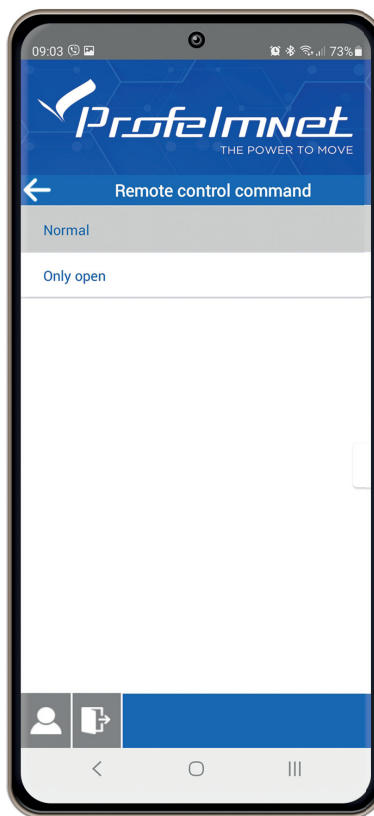
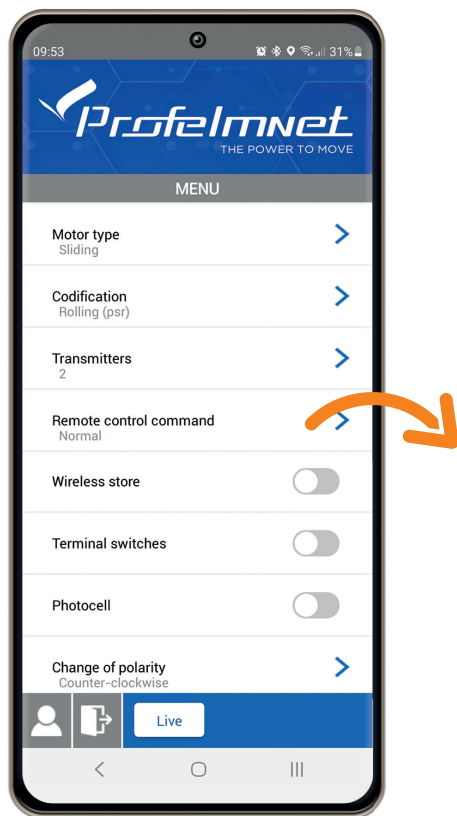

Remote control command

Normal:  
START-STOP-CLOSE

Only Open

## MENU: Settings ON/OFF

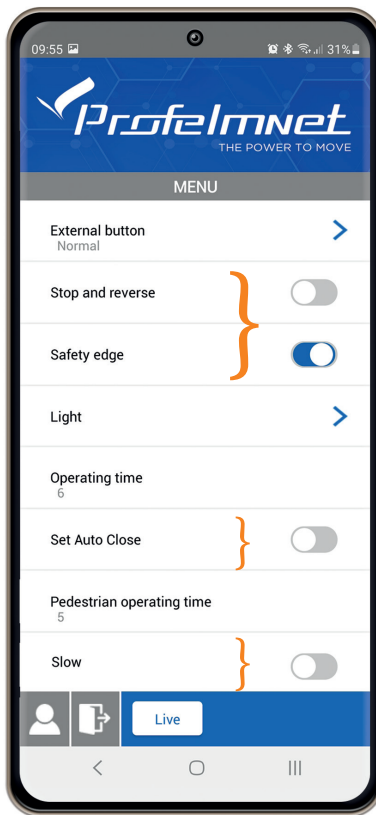
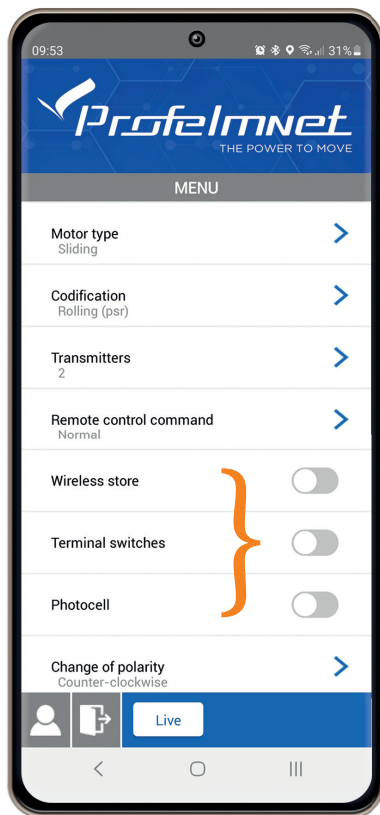

Wireless store  
TerminalSwitches  
Photocell 1  
Photocell 2  
Deceleration  
Stop and Reverse

OFF ☐ ON ☒



## MENU: Change of polarity

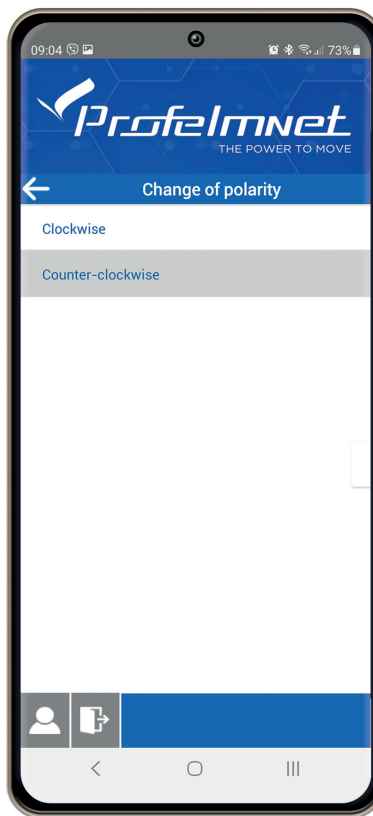
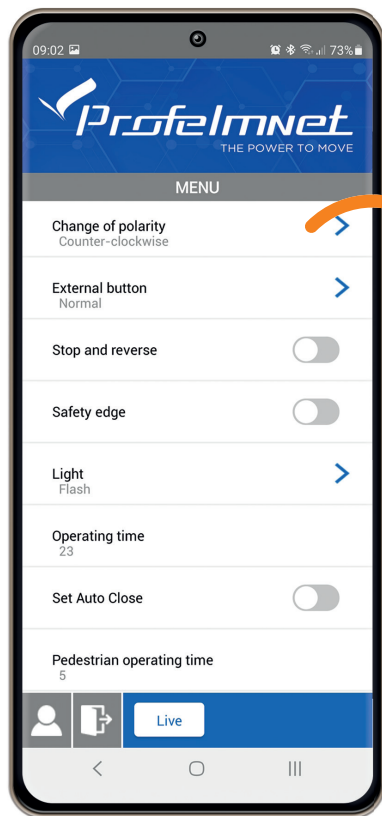

Change the motor and terminal switches polarity based on the installation

### SELECTION CONFIRMATION

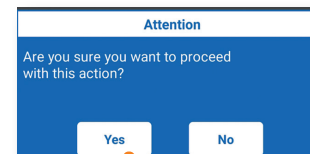

## MENU: External Button

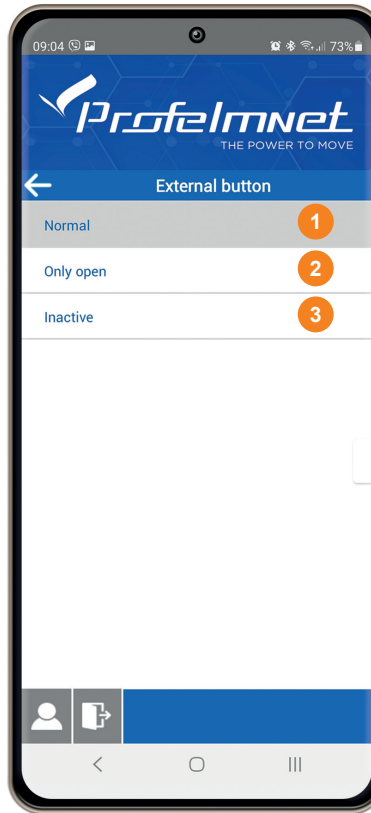
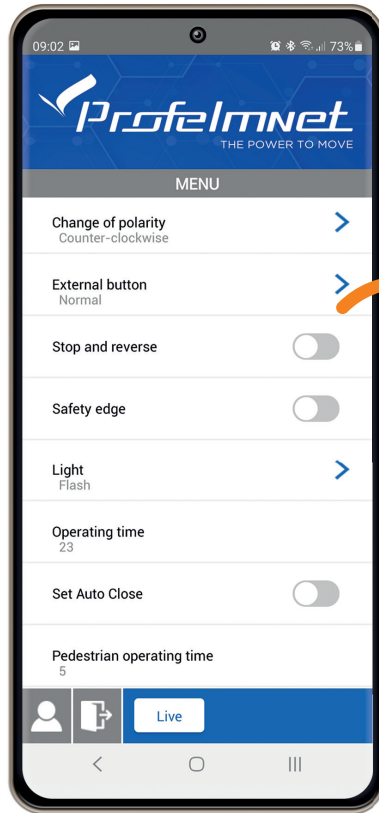

External Button: Select based on the installation

- 1 NORMAL
- 2 ONLY OPEN
- 3 INACTIVE

## MENU: Safety Edge

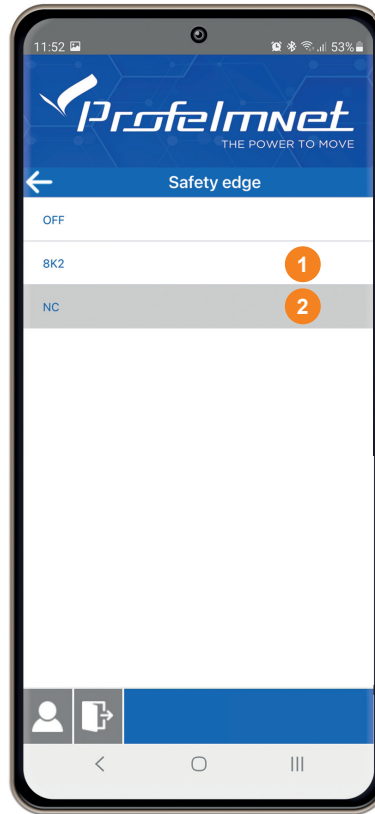
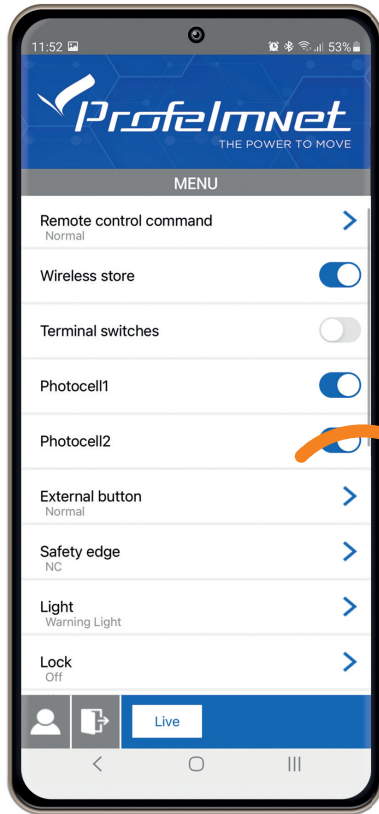

Once the safety contact is activated, the door stops and moves backward by 10 centimeters.

- 1 8K2:** An 8.2 kΩ resistor is used to monitor the contact.
- 2 Closed contact:** Use an NC (Normally Closed) contact for monitoring.

## MENU: Flash

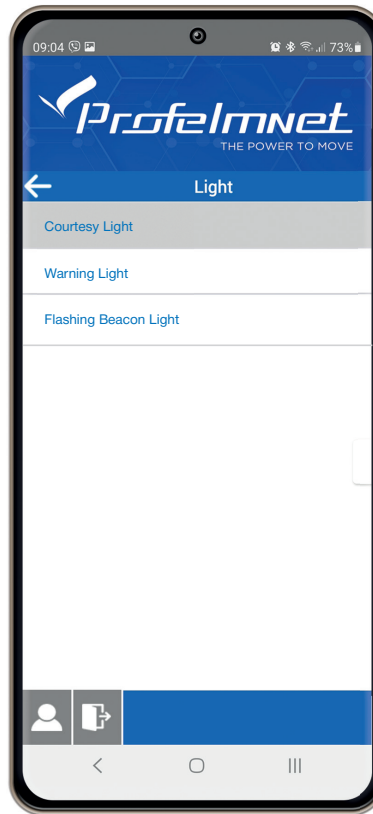
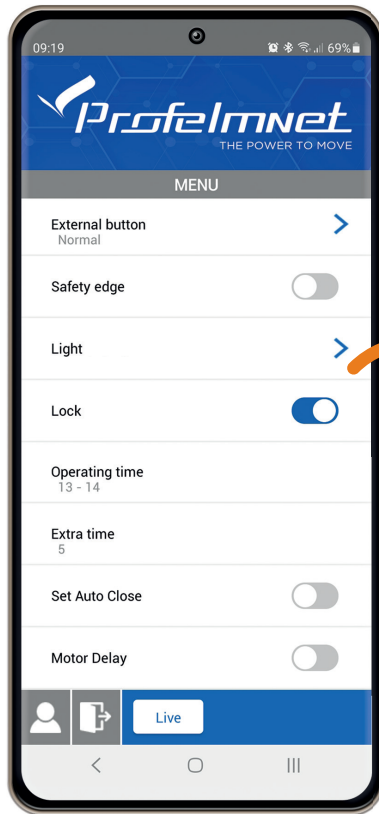

**COURTESY LIGHT:** The light is steady for 3 minutes after the last command.

**WARNING LIGHT:** The light indicates the status of the gate.  
Light Off, gate is closed  
Light On, gate is open  
Slow Flashing, gate is opening  
Fast Flashing, gate is closing

**FLASHING BEACON LIGHT:** The light is flashing during the cycle of the motor.

### SELECTION CONFIRMATION

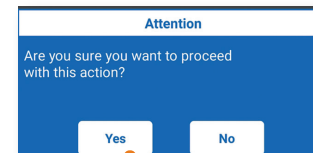

## MENU: Deceleration time

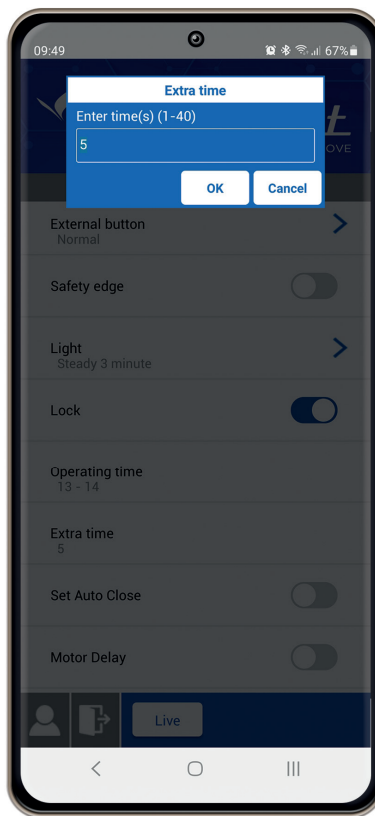
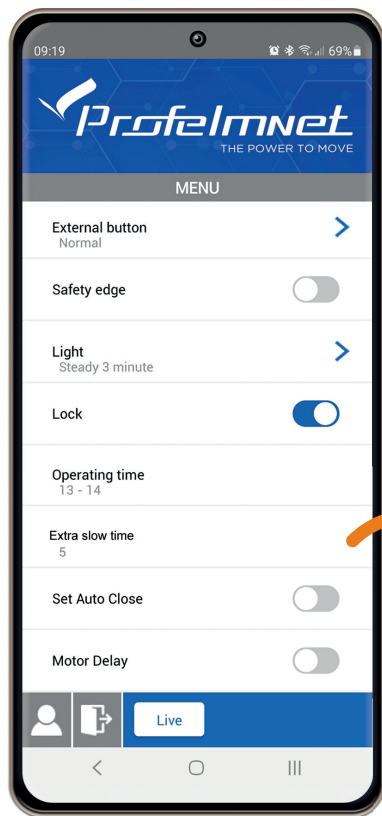

Deceleration time:  
Select based on the installation

SELECTION CONFIRMATION

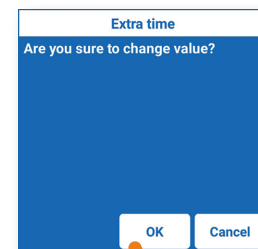



## MENU: Operating Time

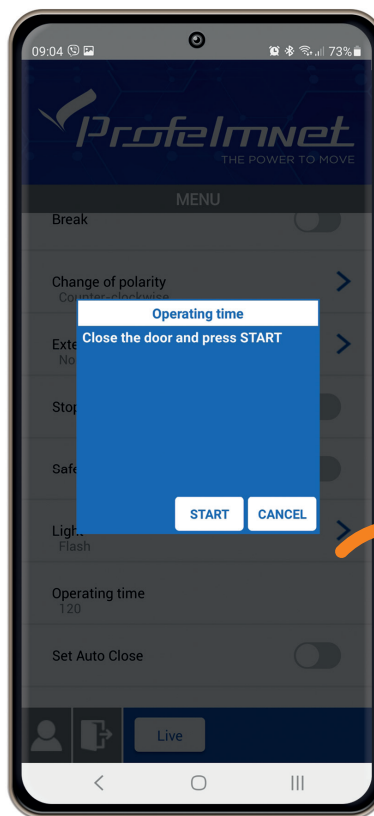
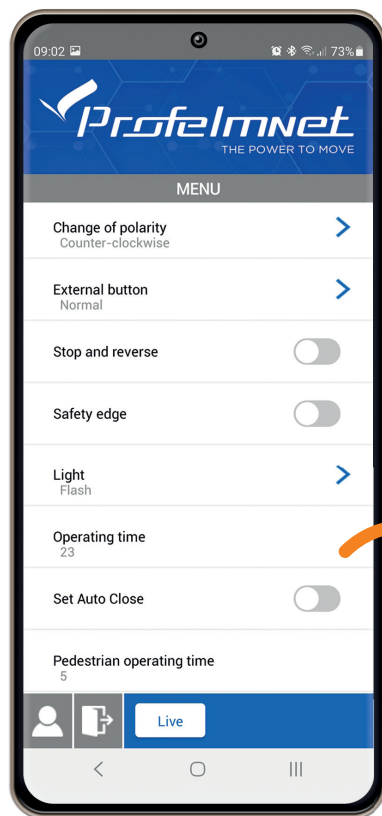

Follow the application steps

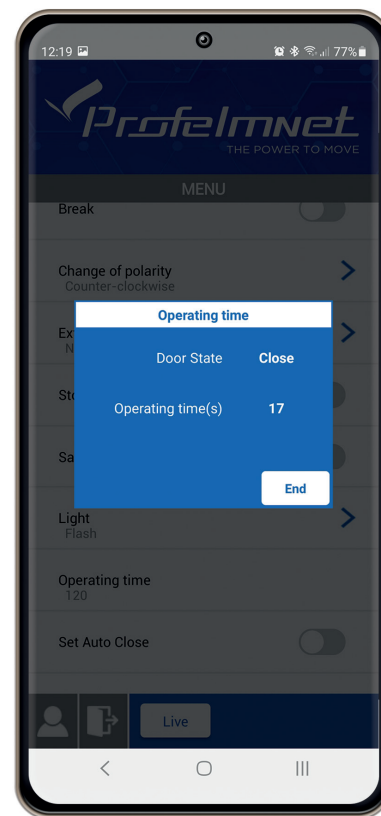

## Operating Time: **FROM THE CONTROL BOARD**

### **SAME OPERATING TIME FOR OPENING AND CLOSING**

#### **1<sup>ST</sup> METHOD: THROUGH CONTROL BOARD**

##### **Using the BUTTON TIME**

Place the gate in the fully closed position.

Press and hold the TIME button firmly.

After 5 seconds, the gate will start opening.

Keep holding the TIME button until the gate reaches the end stop (for sliding gates with limit switches) or the physical stop (for swing gates).

**The operating time is now set.**

#### **2<sup>ND</sup> METHOD: THROUGH REMOTE**

##### **Using a saved remote or external button**

Place the gate in the fully closed position.

**Turn off power of the control board. Press the TIME button and then switch the power back on. When the yellow LED indicator lights up, release the TIME button. The red LED on the board will start blinking.**

- Press the remote control.
- The motor starts to open.
- Press the remote again when the gate is fully open (in case there are no limit switches). If limit switches are installed, the gate will stop automatically at them.

**The operating time is now set.**

## Operating Time: **FROM THE CONTROL BOARD**

### DIFFERENT OPERATING TIME FOR OPENING AND CLOSING

#### 1<sup>ST</sup> METHOD: THROUGH CONTROL BOARD

##### Using the button TIME

Place the gate in the fully closed position.

Turn off power of the control board. Press the CODE button and then switch the power back on. When the yellow LED indicator lights up, release the CODE button. The red LED will start blinking rapidly.

- Briefly press the TIME button.
- The motor starts to open.
- When the gate is fully open, briefly press the TIME button again (if no limit switches are present). If limit switches are installed, the gate will stop at them.
- After 1 second, the motor will start closing automatically.
- When the gate is fully closed, briefly press the TIME button again (if no limit switches are present). If limit switches are installed, the gate will stop at them.

The operating times are now set.

#### 2<sup>ND</sup> METHOD: THROUGH REMOTE

##### Using a saved remote or external button

Place the gate in the fully closed position.

Turn off power of the control board. Press the CODE button and then switch the power back on. When the yellow LED indicator lights up, release the CODE button. The red LED will start blinking rapidly.

- Briefly press the remote.
- The motor starts to open.
- When the gate is fully open, briefly press the remote control again (if no limit switches are present). If limit switches are installed, the gate will stop at them.
- After 1 second, the motor will start closing automatically.
- When the gate is fully closed, briefly press the remote control again (if no limit switches are present). If limit switches are installed, the gate will stop at them.

The operating times are now set.

## MENU: Set auto - close

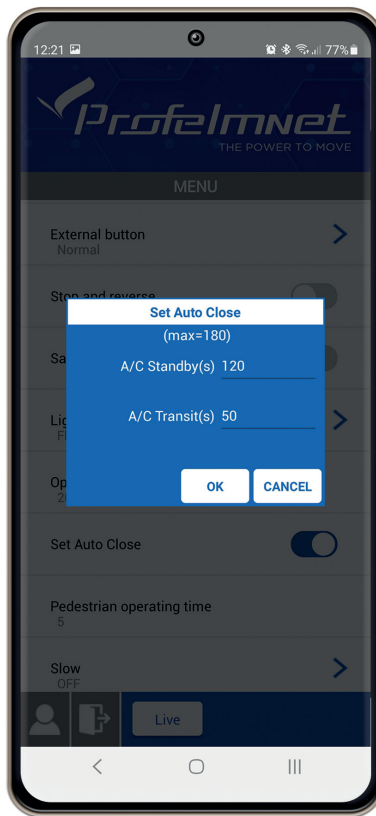
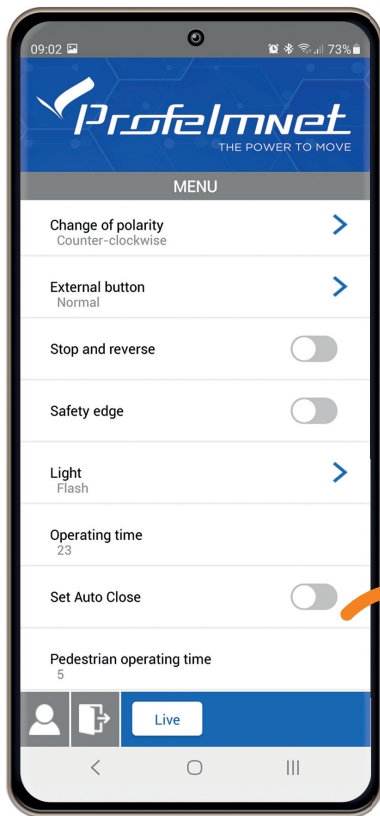

- **Auto-Close Stand-by:**  
*The time when the gate is open and the photocell is not activated*
- **Auto close Transit:**  
*The time when gate is open after the photocell is activated*



### SET TIME:

*Set time on each field in seconds*

*If you want to edit the time, you need to disable the AUTO-CLOSE and re enable it*

OFF ☐ ON ☒

## MENU: Pedestrian operating time

Follow the application steps

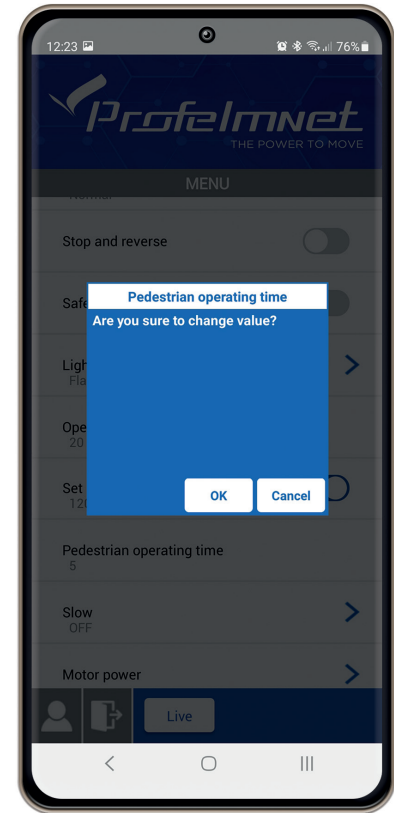
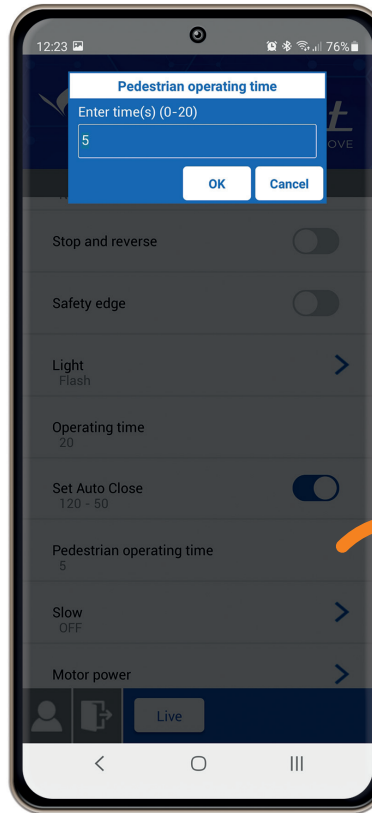
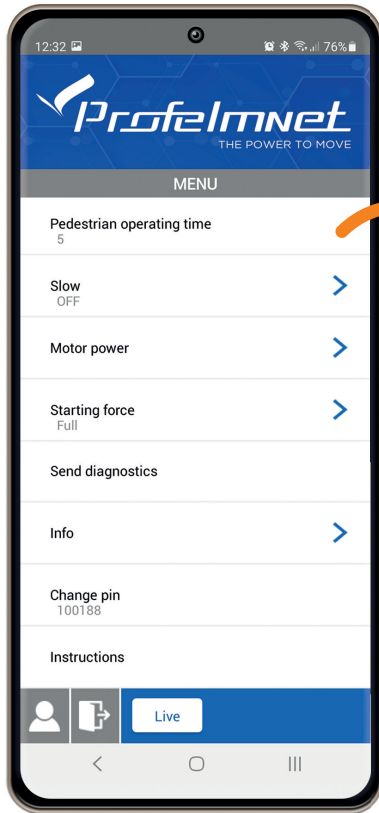

## MENU: Motor Power

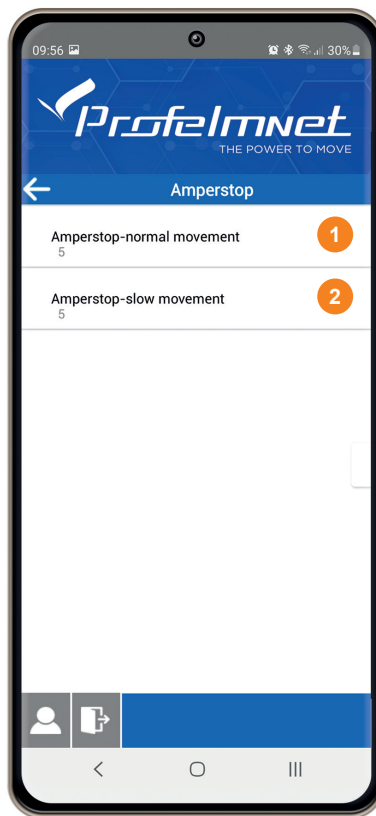
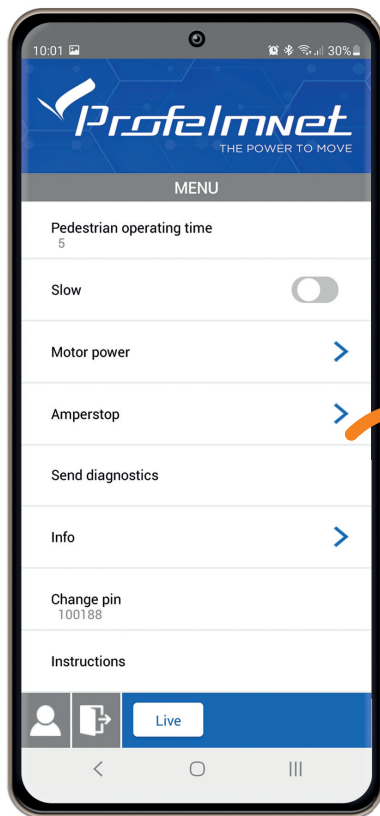

1 Motor power - normal movement  
Enter value

2 Motor power - slow movement  
Enter value

ENTER VALUE

**Amperstop-normal movement**

Enter sensitivity (1-10)

OK Cancel



## MENU: Amperstop

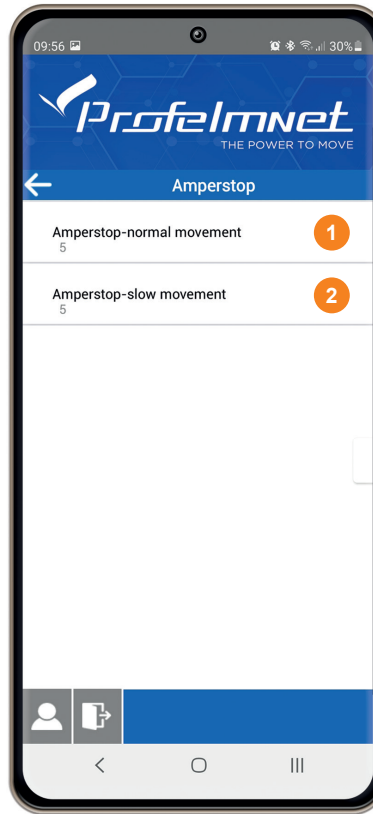
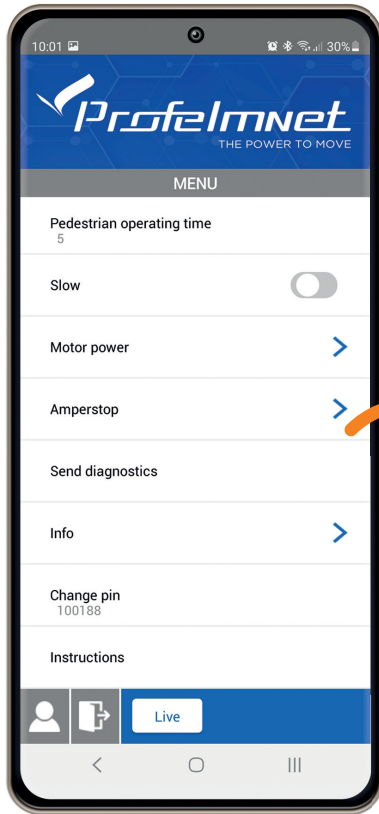

- 1 Amperstop in normal movement
- 2 Amperstop in slow movement

ENTER VALUE

**Amperstop-normal movement**

Enter sensitivity (1-10)

5

OK Cancel



## MENU: Send Diagnostics

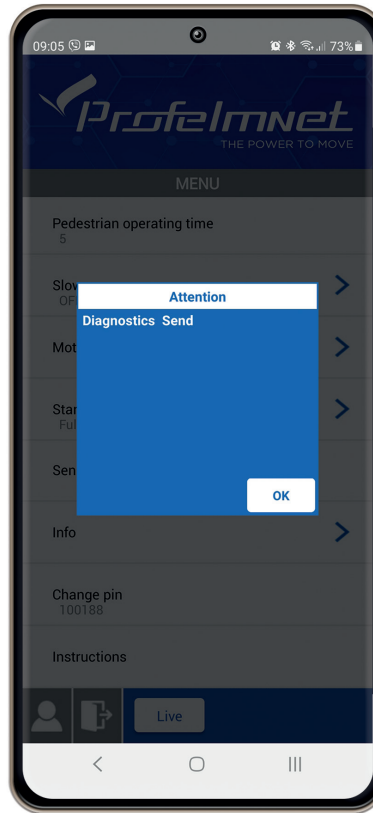
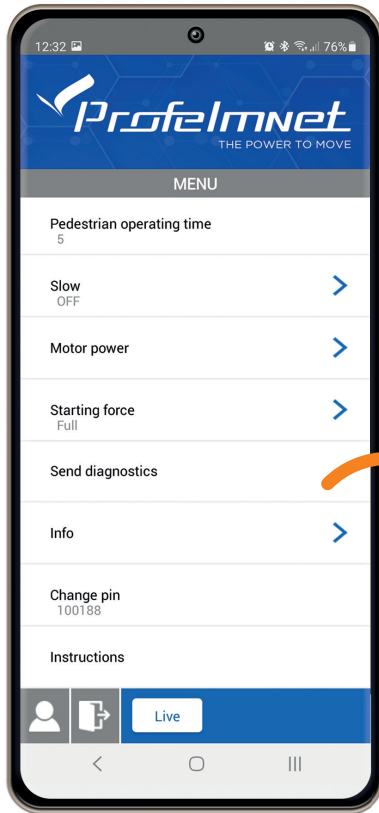

In case of technical support, send diagnostics to the Profelment technician



## MENU: Info

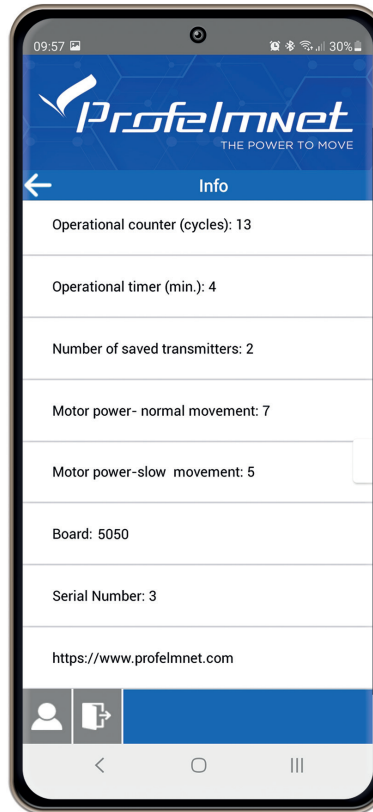
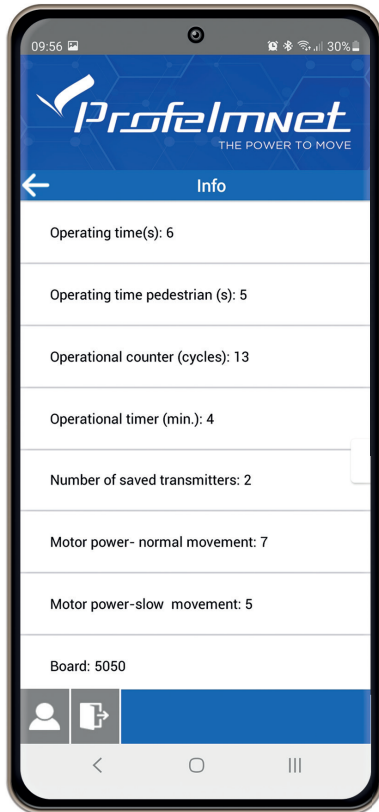

All information of the board

## MENU: Change PIN

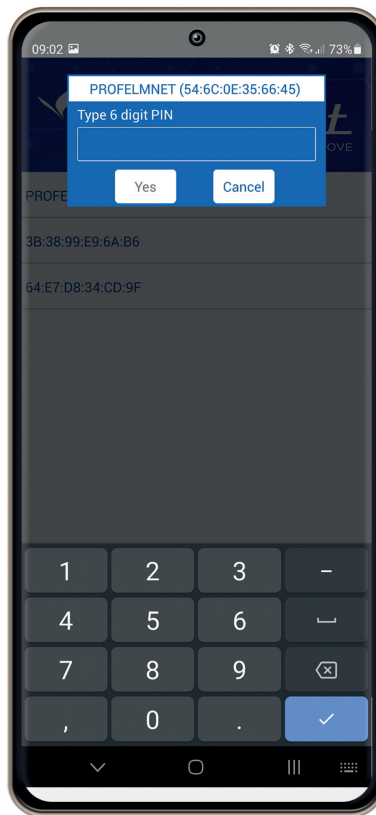
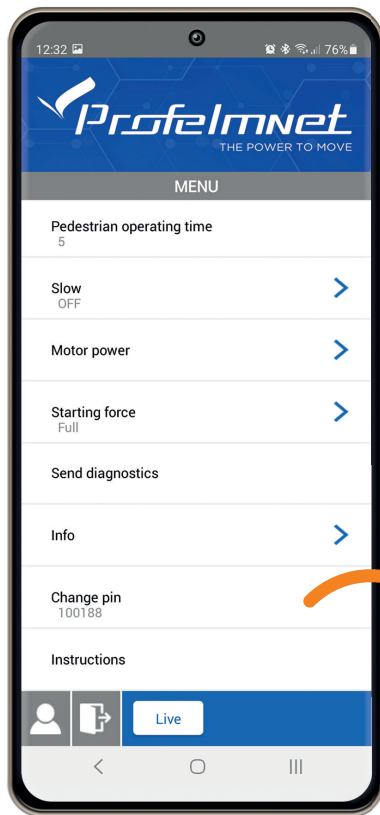

CHANGE PIN

SELECTION CONFIRMATION

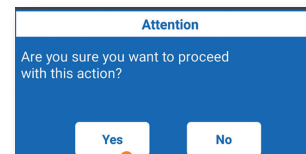



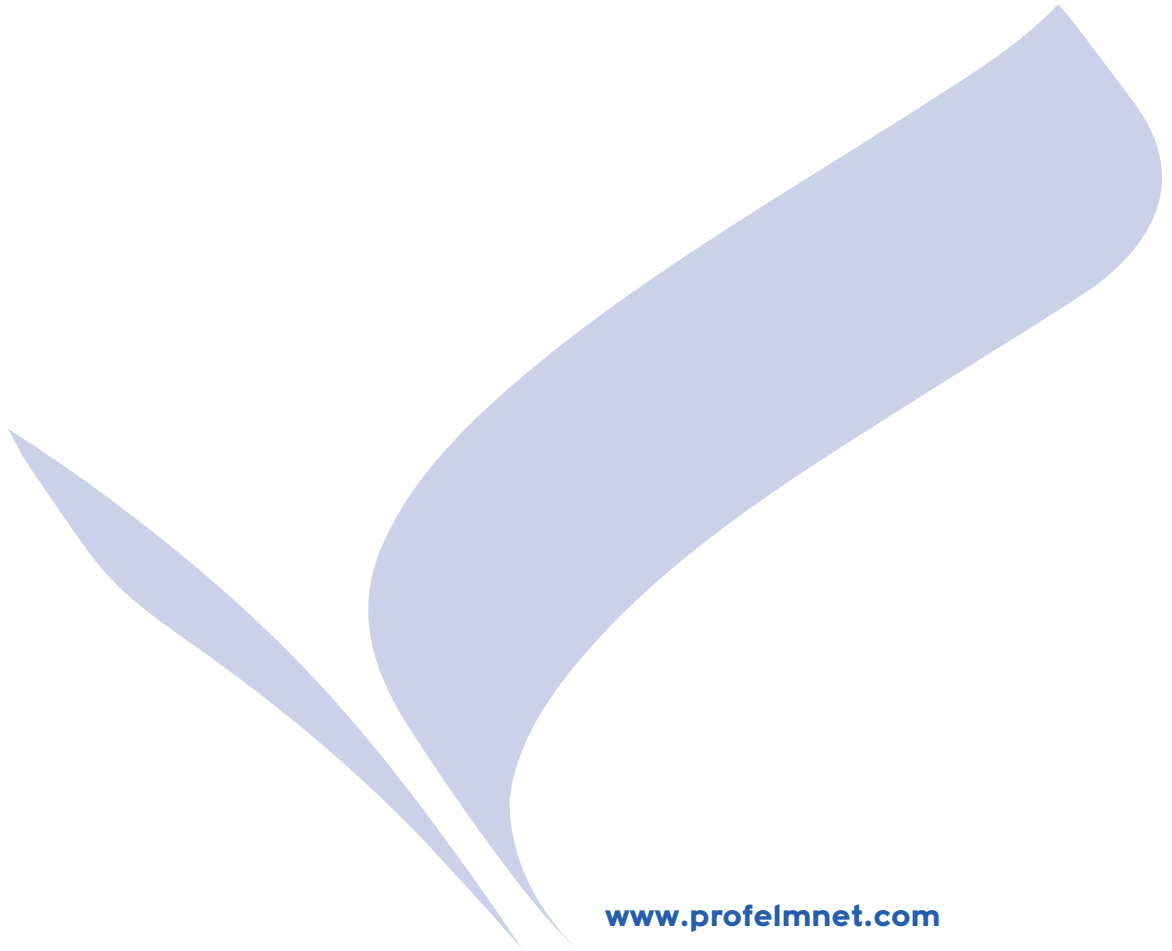

[www.profelmnet.com](http://www.profelmnet.com)