

5614
USER
MANUAL

EASYTECH PRO



SERIES 50

The Series 56 is the complete range of Profelmnet automation systems featuring BLUETOOTH technology. It is combined with the Profelmnet Easy Tech application, available for ANDROID and iOS. Through the Profelmnet Easy Tech application, the technician is able to configure all automation functions using a smartphone, tablet, or computer.

56 14 – Automation system for 2 motors 230VAC

GENERAL INFORMATION

The automation control board has been designed for controlling sliding doors / shutters / residential gates operated by 230VAC motors. It is intended for use in residential and commercial installations and must be installed by personnel with basic technical knowledge of electrical systems and automation. This device is an automation component and not a complete machine. The final installation of the door or gate must comply with the applicable safety requirements of the door itself. The product complies with the essential requirements for safety, electromagnetic compatibility, and radio equipment of the relevant European Directives.

IMPORTANT SAFETY INFORMATION

- The product must be used and installed only in applications for which it was designed
- Keep these instructions for future reference
- Ensure proper grounding is present
- Before carrying out any wiring or programming, disconnect the power supply
- A 6 A / 30mA residual current device (RCD) must be used for power supply

- Do not modify or alter any part of the automation system without prior consultation with Profelmnet
- Do not allow children or pets near the door while it is in operation
- Keep remote controls out of reach of children to prevent accidental operation
- Installation, maintenance, or repair must be carried out by qualified personnel
- Installation of a safety contact for pedestrian protection is mandatory
- Profelmnet, as the manufacturer, reserves the right to modify the product without prior notice
- Any use not described in these instructions is not recommended
- Installation must be carried out with the power supply disconnected

The device must be used only with active safety devices (e.g. photocells or safety edge) to ensure safe operation. After installation, a complete travel test of the door must be performed. Do not operate the door if people, animals, or objects are present in its path

Before use, the installer must ensure that the door moves freely and without mechanical resistance

TECHNICAL SPECIFICATIONS

- Operating voltage: 230VAC 50Hz
- Motor output: 230VAC
- Accessories output: 24VDC
- Operating temperature: -20°C to +60°C
- Remote control receiver: Rolling code or Fixed code, depending on the model

MANDATORY USE OF PHOTOCELLS

For safe operation of the door, the installation of photocells is mandatory in every new automation installation.

Operating the door without active safety devices makes the system non-compliant with EN 12453 safety requirements.

The door must not operate without an active photocell.

If the photocells are not connected or are not operational, the system must be used only in manual mode.

OPERATIONAL TEST PROCEDURE

After installation:

Verify that the door moves smoothly without obstruction

Check correct operation of the photocells

Check the limit switches

Perform 5 complete opening/closing cycles

Ensure that the manual release mechanism operates correctly

INSTALLATION RESPONSIBILITY

Profelmnet bears no responsibility for the final installation of the door or for improper or incomplete use of the product.

Correct installation and adjustment of safety devices (photocells, safety edge, motor force settings) are the responsibility of the installer or the individual completing the installation.

Operating the door without installed safety devices is prohibited and may cause injury or damage.

Profelmnet supplies only the automation equipment and is not the manufacturer of the final door or gate.

CE DECLARATION OF CONFORMITY



According to Directive 2006/42/EC (Machinery Directive), the manufacturer: L. PSARROS & SIA OE declares that the following product: 5614 – Automation system for 2 motors 230VAC is an automation component and not a complete machine, and complies with the requirements of the following European Directives: 2014/53/EU – Radio Equipment Directive (RED) - 2014/30/EU – Electromagnetic Compatibility Directive (EMC). The product complies with the essential requirements and relevant provisions applicable to it. The integrated Bluetooth radio module complies with Directive 2014/53/EU (RED) and operates in the 2.4GHz frequency band in accordance with European regulations. Final installation and commissioning.

MANUFACTURER CONTACT DETAILS:

PROFELMNET L. PSARROS & SIA OE

Address:

11 Proedrou Drakaki Street
17341 Agios Dimitrios, Athens, Greece

Phone:

+30 210 9850244
+30 697 4894108 (Technical Support)

Email:

info@profelmnet.com

5614 Control board for double motors 230VAC

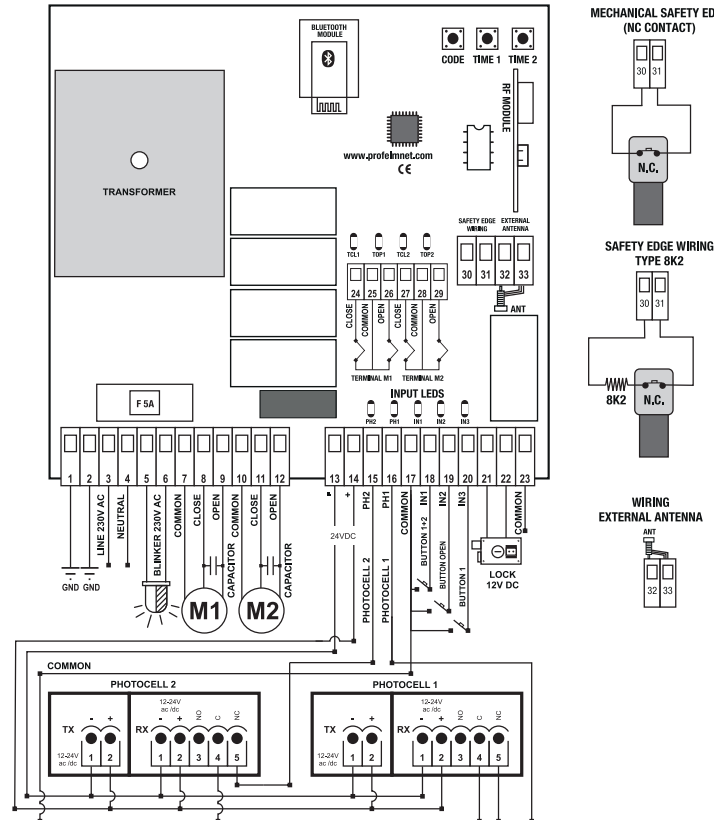

TECHNICAL CHARACTERISTICS

Power supply	230VAC /50 Hz
Max. Motor power	1400W
Box dimensions	25cm X19.5cm X10cm
Control board dimensions	13cm X13.5cm X 4.5cm
Fuse 230VAC	5A
Fuse 12-24VDC	200mA
Blinker light power supply	230VAC/100W
Photocell power supply	24VDC
Lock power supply	12VDC /3A
Remotes memory	Removable memory up to 300 remotes
Temperature	-20oC + 60oC

ELECTRICAL CONNECTIONS

1	Ground	17	Common accessories
2	Ground	18+17	Command Button 1+2 - N.O
3	Line	19+17	Command Magnetic Loop - N.O
4	Neutral	20+17	Command Only Motor 1 N.O
5-6	Blinker light	21+22	Lock 12VDC 3A
7	Common motor 1	23	Common
8	Close Motor 1 + Capacitor	24+25	Close terminal switch motor 1-N.C
9	Open Motor 1 + Capacitor	25	Common terminal switch motor 1
10	Common motor 2	26+25	Open terminal switch motor 1-N.C
11	Close Motor 2 + Capacitor	27+28	Close terminal switch motor 2-N.C
12	Open Motor 2 + Capacitor	28	Common terminal switch motor 2
13	Power Supply - 24VDC	29+28	Open terminal switch motor 2-N.C
14	Power Supply + 24VDC	30+31	Safety Edge - NC /8K2
15+17	Photocell 2	32	External Antenna 433,92MHz
16+17	Photocell 1	33	Shield Antenna 433,92MHz

SETTINGS - CONFIGURATION - 5614

ACTIVATE INTERNET AND BLUETOOTH  OF YOUR DEVICE
DOWNLOAD THE PROFELMNET EASYTECH PRO APPLICATION

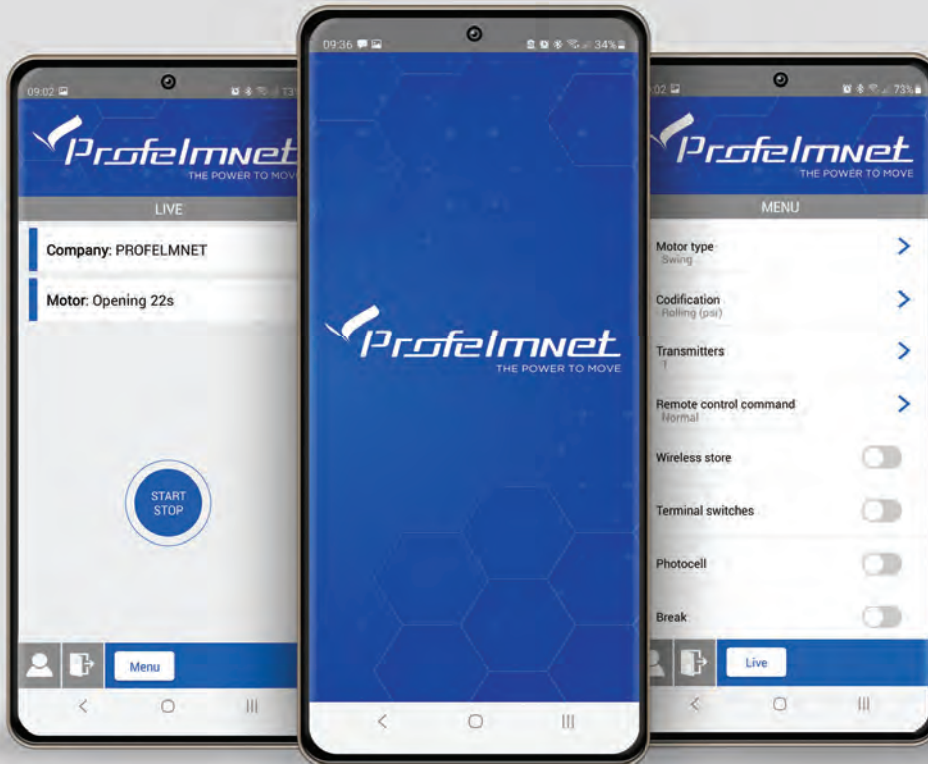

ProfelmNet
EasyTech Pro



REGISTER

FOLLOW THE STEPS TO REGISTER

- 1 Choose the language
- 2 Press Register & fill in your personal data
- 3 Scan QR code. Find the QR code on the board & scan it
- 4 Press sign up to finish

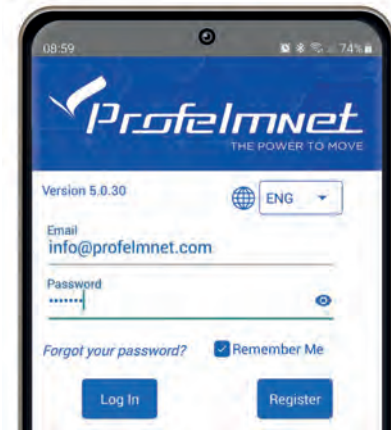
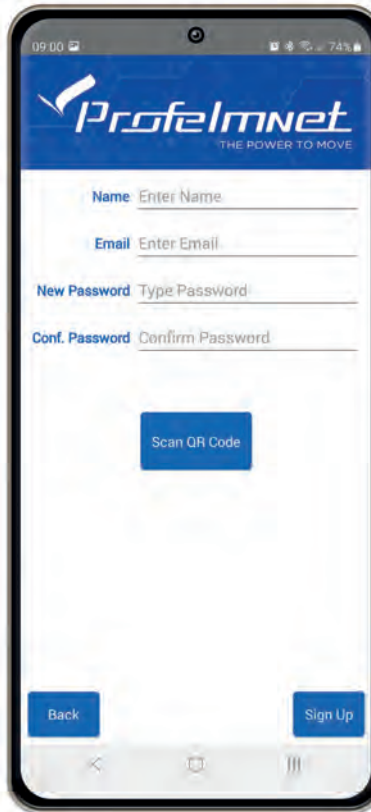
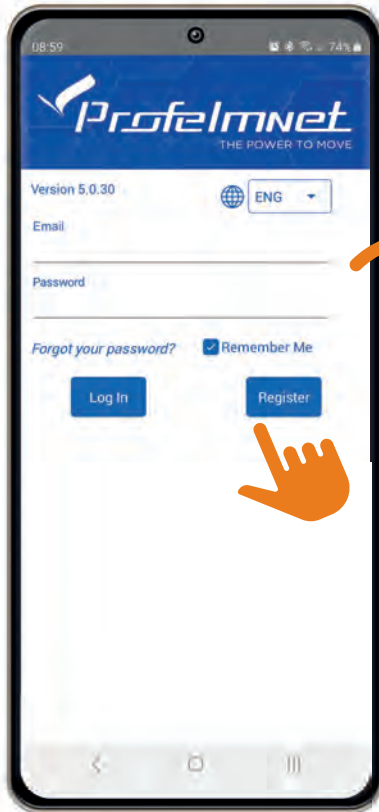

CONNECTION with the board

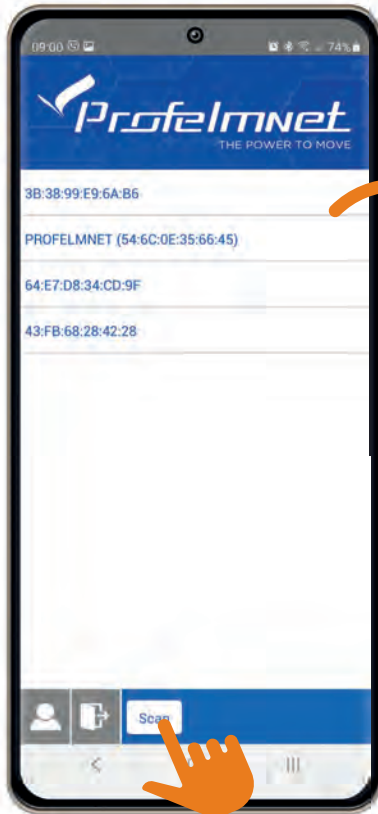

- 1 Press scan to find the PROFELMNET device
- 2 Choose the PROFELMNET device
- 3 Type the 6 Digit PIN

During the first connection, type 000000 PIN and then type your personal 6-digit PIN.



The PIN code is your personal security number. Without this PIN code, you can not access the board. Avoid using simple easy PIN codes (i.e 111111)

LIVE SCREEN

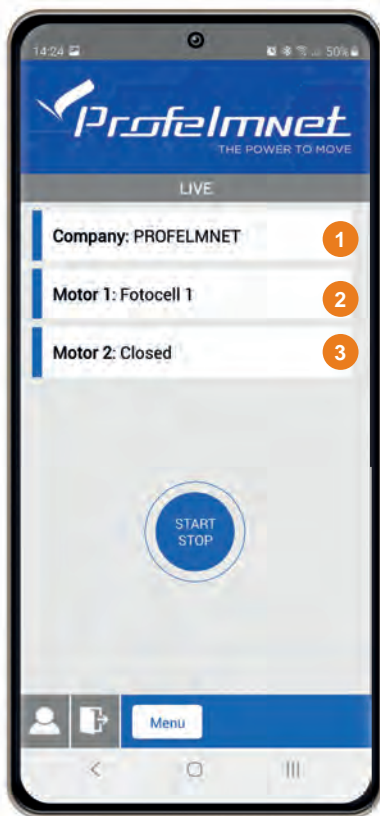

- 1 Company: Board Supplier
- 2 Motor 1: Installation Info
- 3 Motor 2: Installation Info



USER PROFILE:
Edit your personal data

SWITCH LIVE SCREEN TO MENU SCREEN

Download the complete
manual configuration

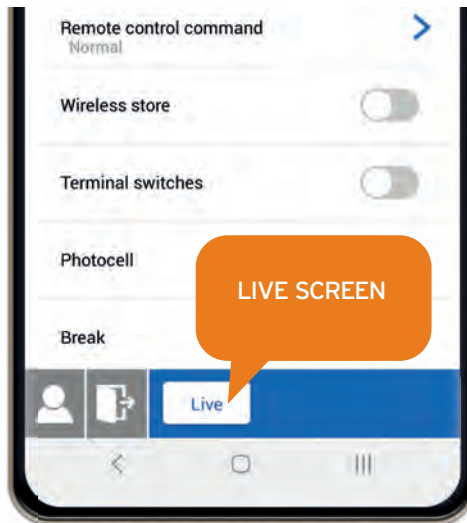
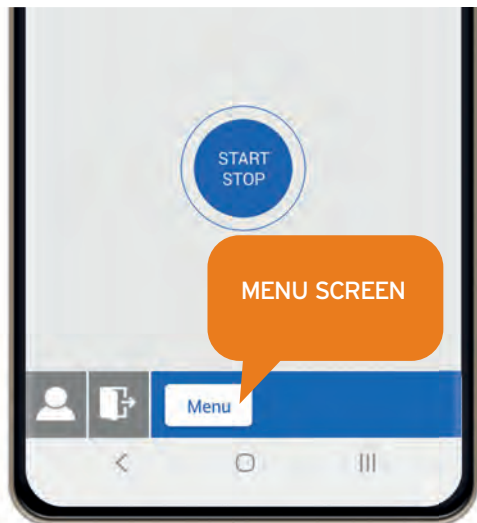

MENU: Codification

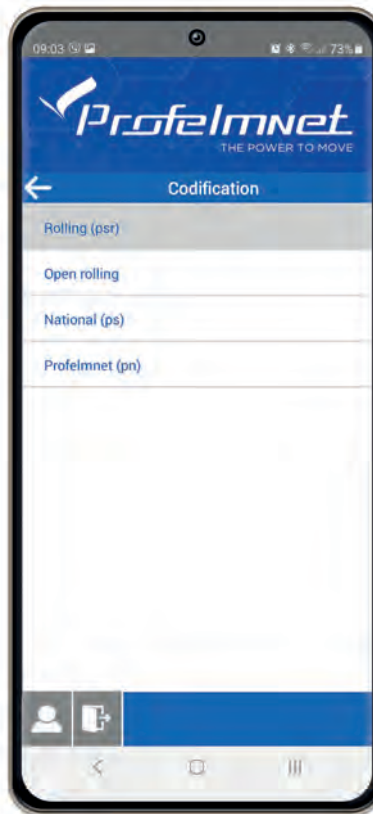
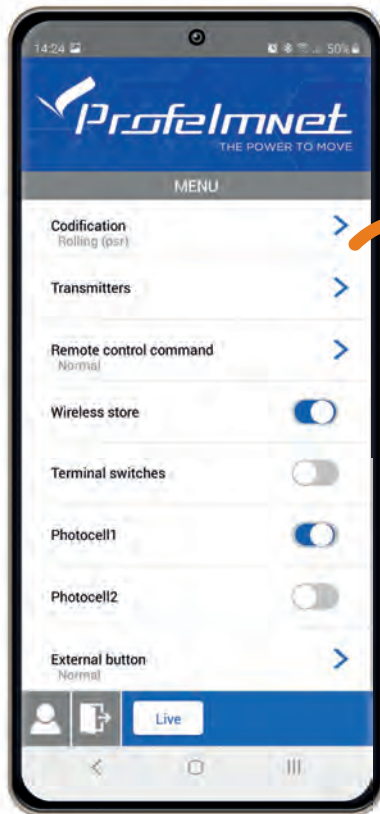

Codification: Select based on the installation's transmitters

MENU: Transmitters

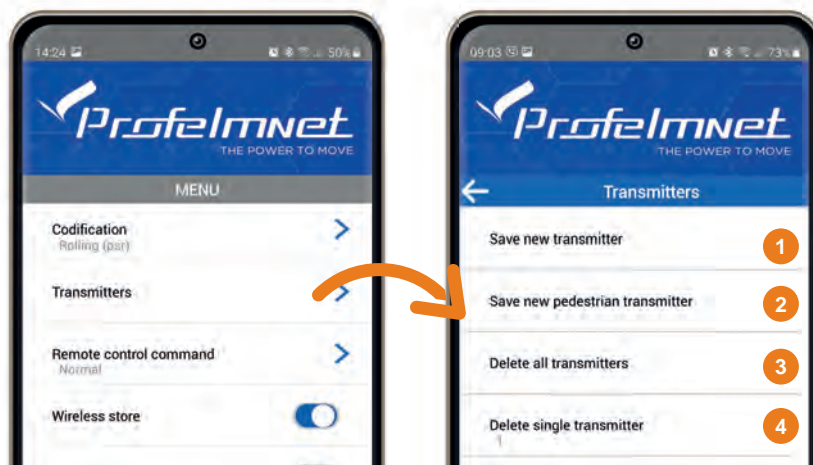

- 1 **Save new transmitter:**
Press the transmitter button you want to save
- 2 **Save new pedestrian transmitter:**
Press the transmitter button you want to save as pedestrian
- 3 **Delete all transmitters:**
YES/NO
- 4 **Delete single transmitter:**
Choose the number of transmitter to DELETE.

Adding a new remote remotely: The motor is fully closed or open. Press a working remote button (already in memory) to start the motor working and hold it pressed until the motor stops. When it stops, leave it and press the new remote button immediately. The new remote is saved. Repeat steps to program more remotes remotely. When the memory is full (300 remotes) you cannot add more new remotes

TIP

COMPATIBLE REMOTES: Based on the model you have

PS: Fixed Code 433,92MHz. Compatible remotes are fixed code 433,92MHz

PSR/PN: Rolling Unique Code 433,92MHz. Compatible Remotes with same Unique Rolling Code.

WHERE YOU FIND THE UNIQUE ROLLING CODE OF THE BOARD: On the control board, there is a white productions sticker by Profelmnet. You will find the Unique Rolling Code, with which you search for compatible controls.

TIP

ADDING A NEW TRANSMITTER WITH THE CONTROL BOARD CODE BUTTON: Press the CODE button and the RED indication light goes ON. Leave it and during the next 3 seconds, press the desired transmitter channel button until the RED indication light blinks and goes OFF. The new transmitter is saved. Follow the same procedure to program more (up to 300 remotes) new remotes.

MENU: Remote control Command

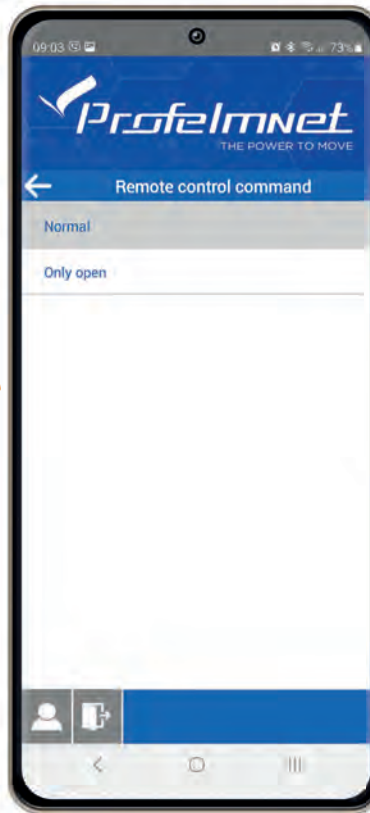
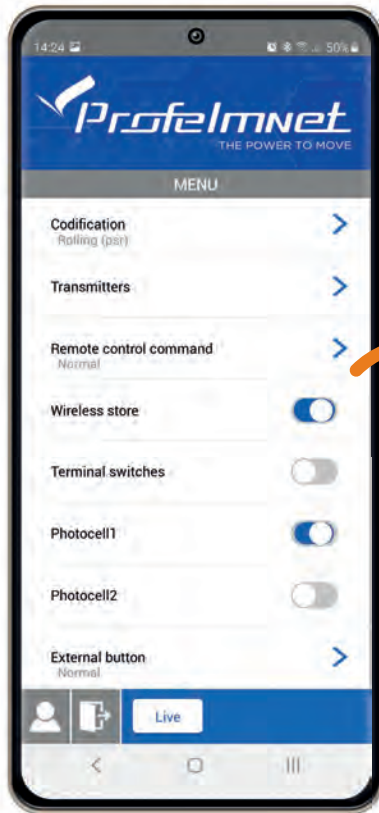

Remote control command

Normal:
START-STOP-CLOSE

Only Open

MENU: Settings ON/OFF

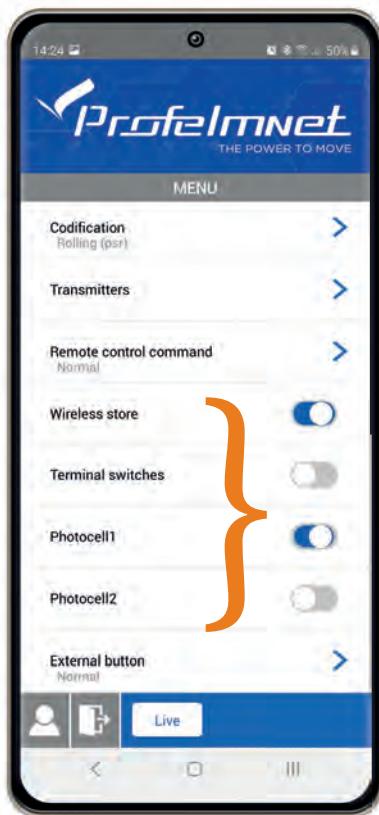

SETTINGS - CONFIGURATION - 5614

MENU: Lock

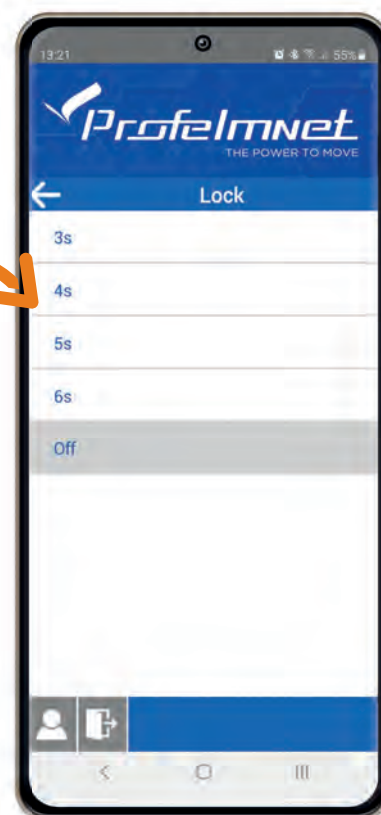
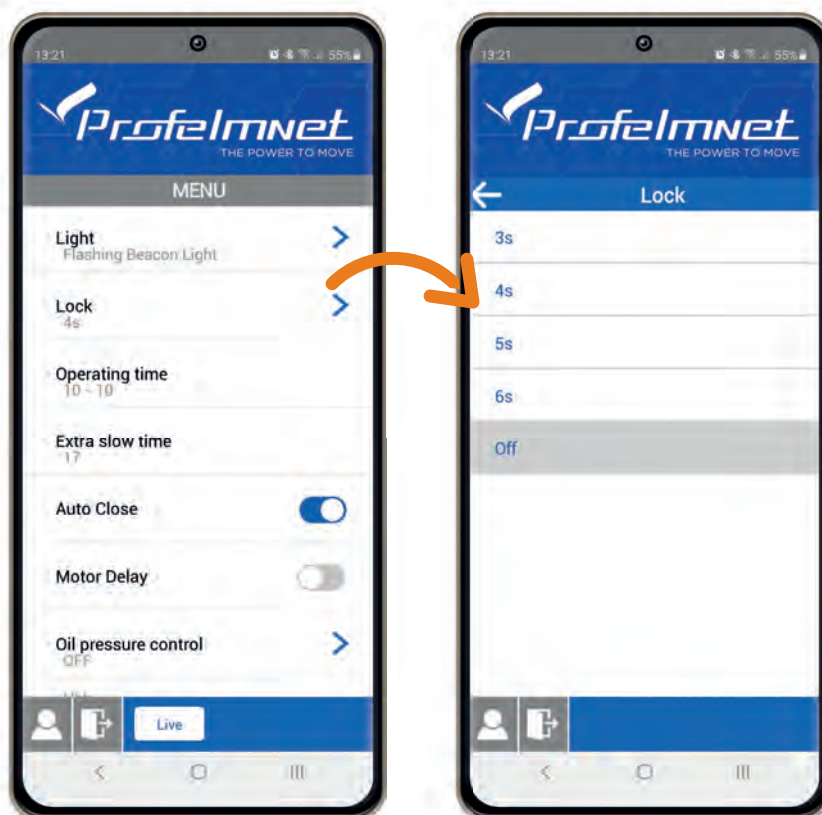

13

MENU: External Button

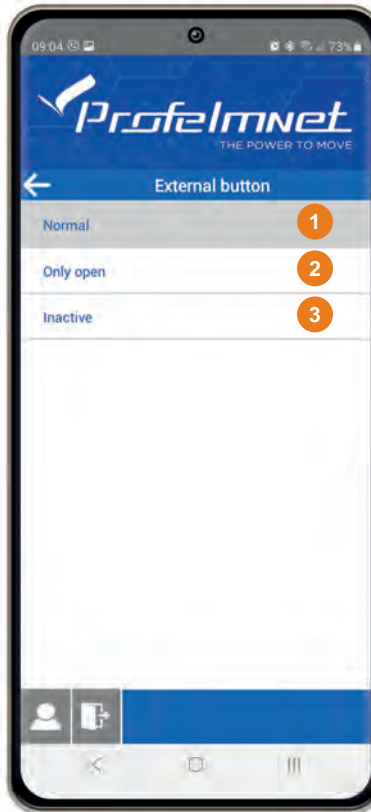
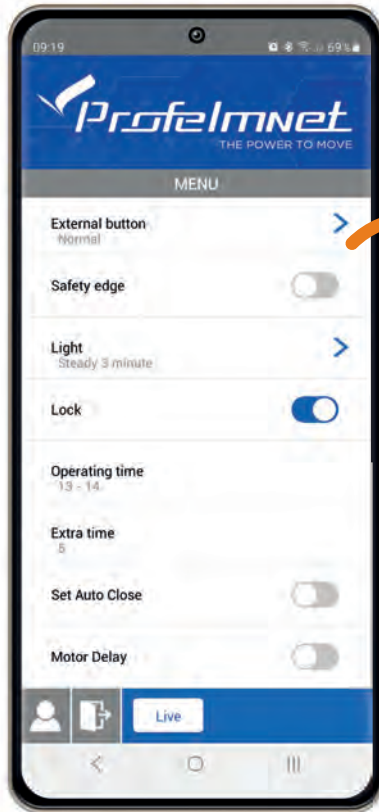

External Button: Select based on the installation

- 1 NORMAL
- 2 ONLY OPEN
- 3 INACTIVE

MENU: Flash

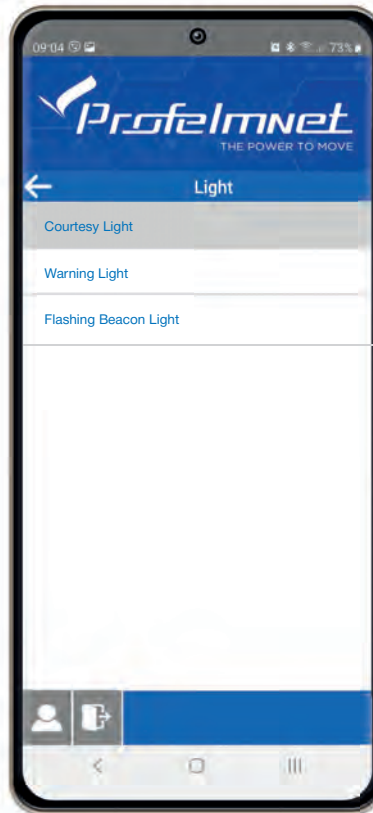
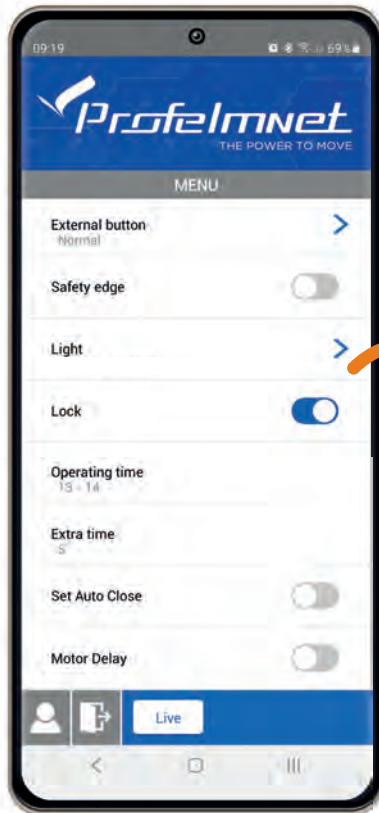

COURTESY LIGHT: The light is steady for 3 minutes after the last command.

WARNING LIGHT: The light indicates the status of the gate.
Light Off, gate is closed
Light On, gate is open
Slow Flashing, gate is opening
Fast Flashing, gate is closing

FLASHING BEACON LIGHT: The light is flashing during the cycle of the motor.

SELECTION CONFIRMATION

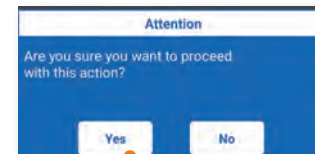

MENU: Operating time - motor 1 & motor 2

Follow the application steps

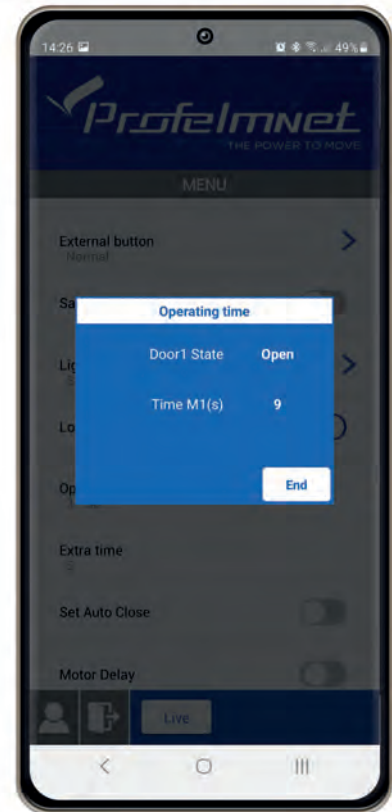
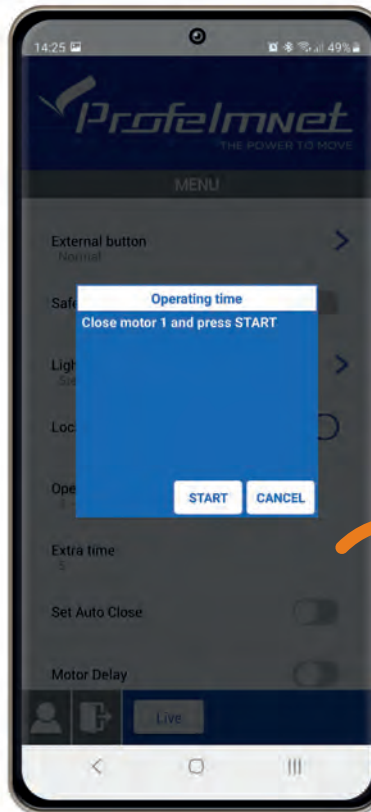
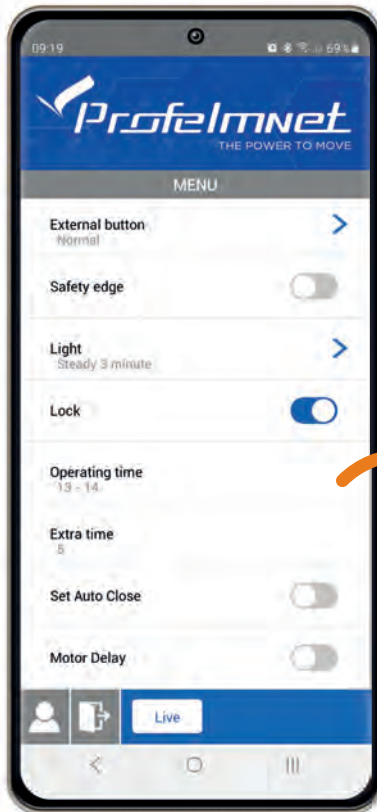

Operating Time: **FROM THE CONTROL BOARD**

**SAME WORKING TIME FOR OPEN + CLOSE
FOR EACH LEAF**



*Before setting the working time of the motors, make sure that you have installed **PHYSICAL STOPS** at the closing and opening of each leaf, otherwise the control board cannot be adjusted correctly. In case there are no physical stops, your motor must have built-in **MECHANICAL STOPS**.*

1ST METHOD: THROUGH CONTROL BOARD

- 1 Use the Buttons **TIME 1 + TIME 2**
BOTH LEAVES ARE CLOSED.

Press and hold pressed the **TIME 1** button until the first leaf is fully opened.

Press and hold pressed the **TIME 2** button until the second leaf is fully opened.

The operating time of the two Motors have now been set.

2ND METHOD: THROUGH REMOTE

- 2 Use the saved remote or the external button
BOTH LEAVES ARE CLOSED.

Press the **TIME 1 + TIME 2** buttons simultaneously. The red LED indicator starts flashing.

Press the remote.

Motor 1 opens.

When Motor 1 is fully open, press the remote again.

Motor 1 stops and Motor 2 starts opening automatically.

Press the remote when Motor 2 is fully open.

The operating time of the two Motors have now been set.

Operating Time: **FROM THE CONTROL BOARD**

DIFFERENT WORKING TIME FOR OPEN + CLOSE FOR EACH LEAF

1ST METHOD: THROUGH CONTROL BOARD

1 Use button TIME 1 BOTH LEAVES ARE CLOSED

Press the CODE + TIME 2 buttons simultaneously. The red LED indicator starts flashing quickly.

Press the TIME 1 once.

The Motor 1 opens.

When Motor 1 is fully open, press the TIME 1 once.

Motor 1 stops and after 1 second, Motor 2 starts opening automatically.

When Motor 2 is fully open, press the TIME 1 once.

Motor 2 stops and after 1 second, Motor 2 starts to close automatically.

When Motor 2 completely closed, press the TIME 1 once.

Motor 2 stops and after 1 second, Motor 1 starts to close automatically.

When Motor 1 completely closed, press the TIME 1 button once.

The operating time of the two Motors have now been set.

2ND METHOD: THROUGH REMOTE

1 Use the saved remote or the external button BOTH LEAVES ARE CLOSED

Press the CODE + TIME 2 buttons simultaneously. The red LED indicator starts flashing quickly.

Press the remote once.

The Motor 1 opens.

When Motor 1 is fully open, press the remote once.

Motor 1 stops and after 1 second, Motor 2 starts opening automatically.

When Motor 2 is fully open, press the remote once.

Motor 2 stops and after 1 second, Motor 2 starts to close automatically.

When Motor 2 completely closed, press the remote once.

Motor 2 stops and after 1 second, Motor 1 starts to close automatically.

When Motor 1 completely closed, press the remote once.

MENU: Deceleration time

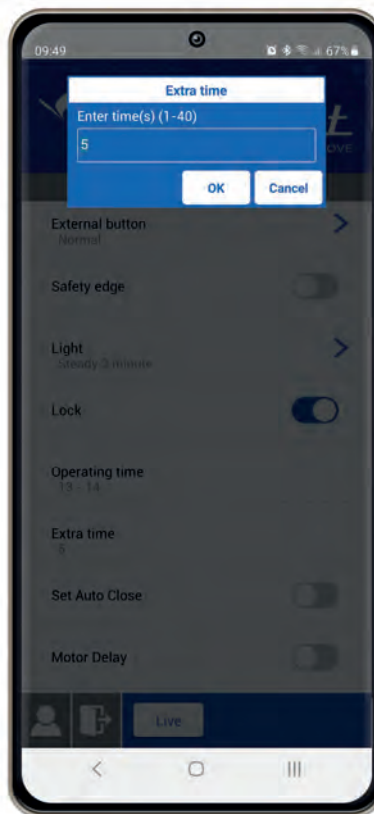
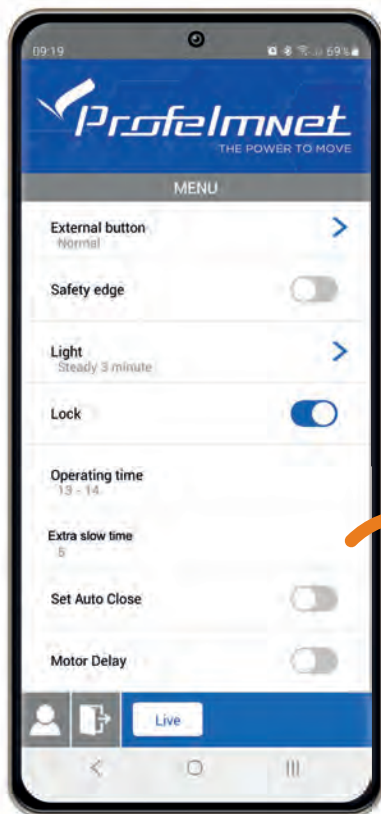

Deceleration time:
Select based on the installation

SELECTION CONFIRMATION

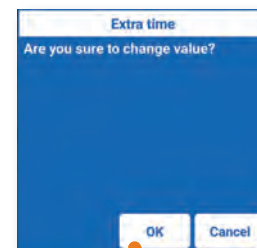

MENU: Set auto - close

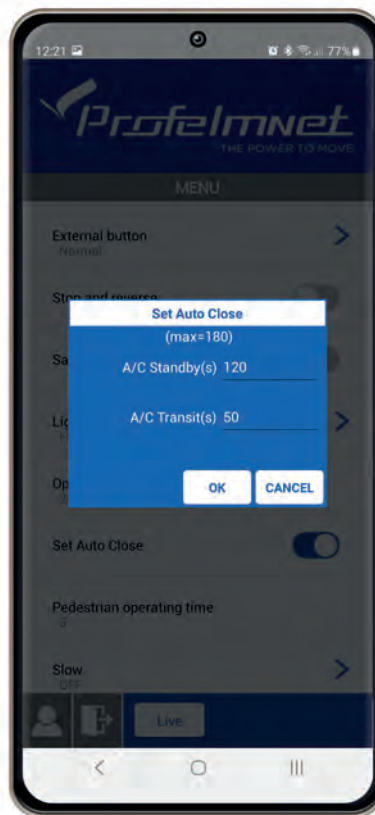
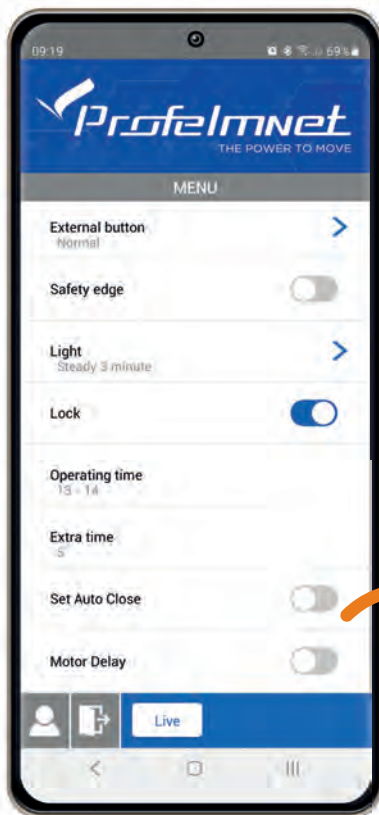

- **Auto-Close Stand-by:**
The time when the gate is open and the photocell is not activated
- **Auto close Transit:**
The time when gate is open after the photocell is activated



SET TIME:

Set time on each field in seconds

If you want to edit the time, you need to disable the AUTO-CLOSE and re enable it

OFF ☐ ON ☒

MENU: Deceleration

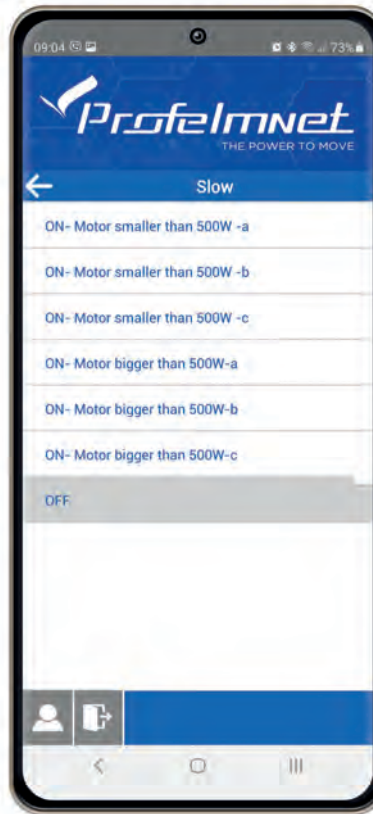
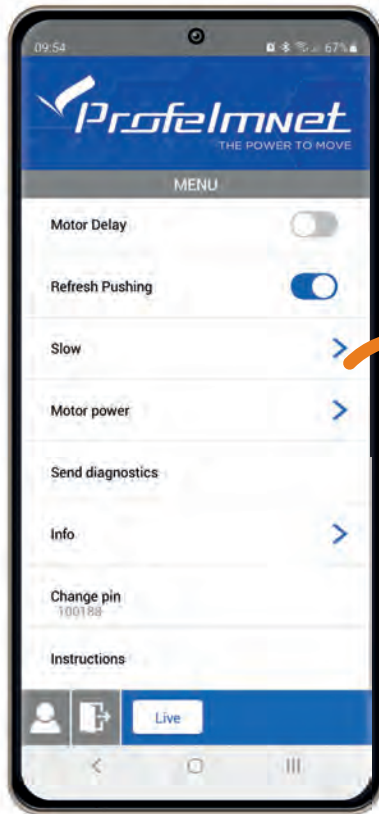

DECELERATION

Select based on the installation



Recommended Factory Settings:

- 1. Motor less than 500 watt:
Choice A*
- 2. Motor more than 500 watt:
Choice A*

MENU: Motor Power

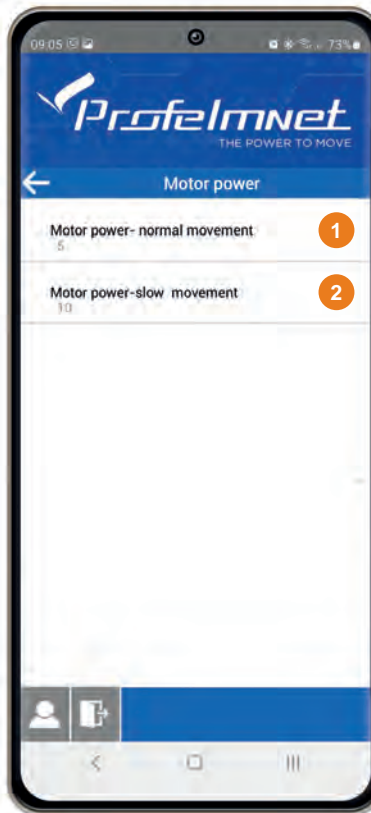
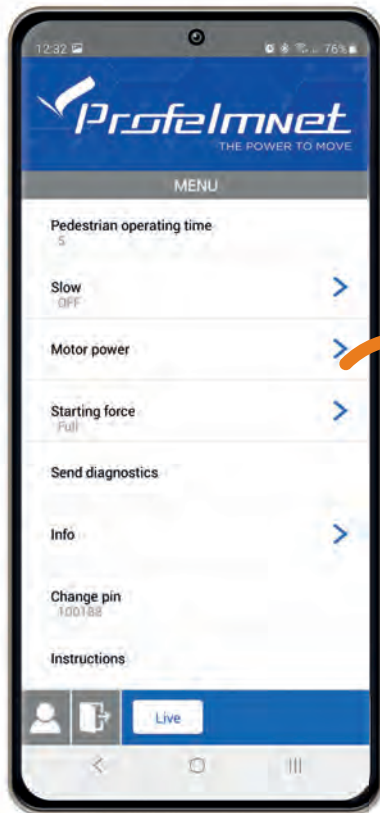

- 1 Motor power - normal movement:
Enter value
- 2 Motor power - slow movement:
Enter value

ENTER VALUE:

Motor power- normal movement

Enter value (1-10)

5

OK Cancel

MENU: Send Diagnostics

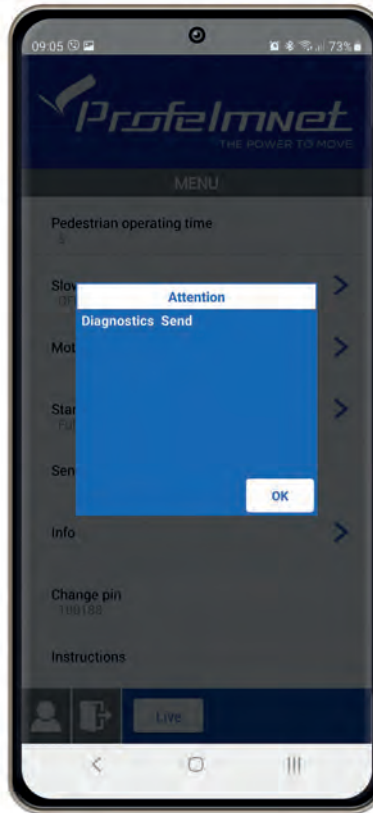
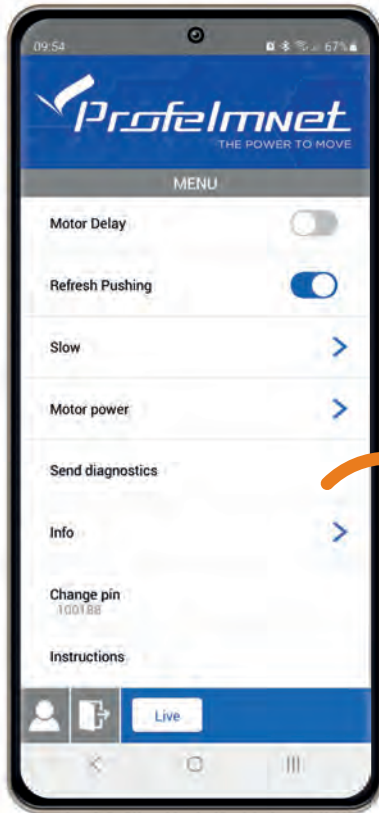

In case of technical support, send diagnostics to the Profelment technician

MENU: Info

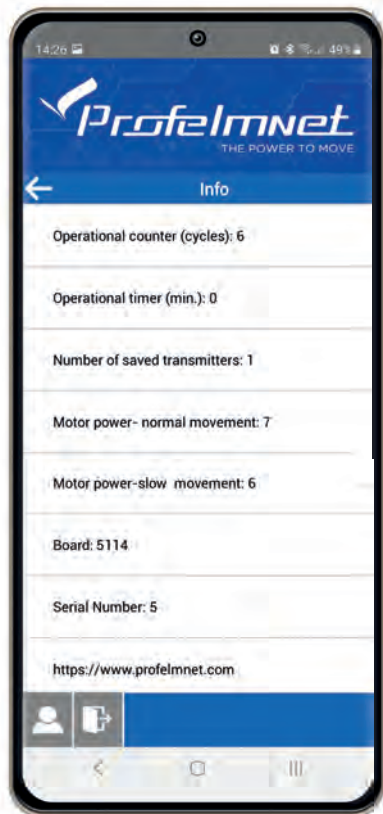

All information of the board

MENU: Change PIN

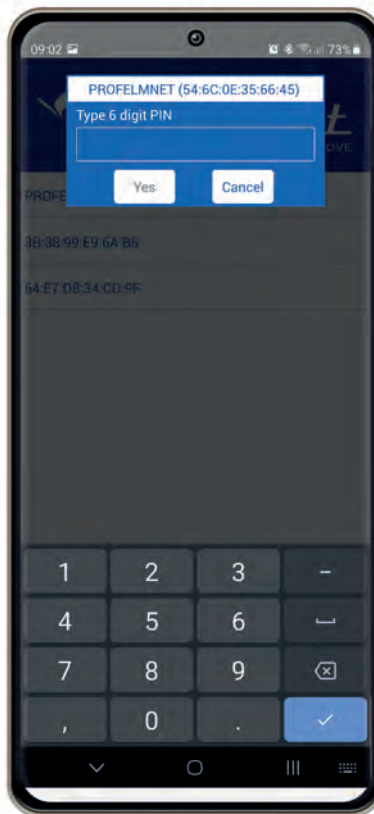
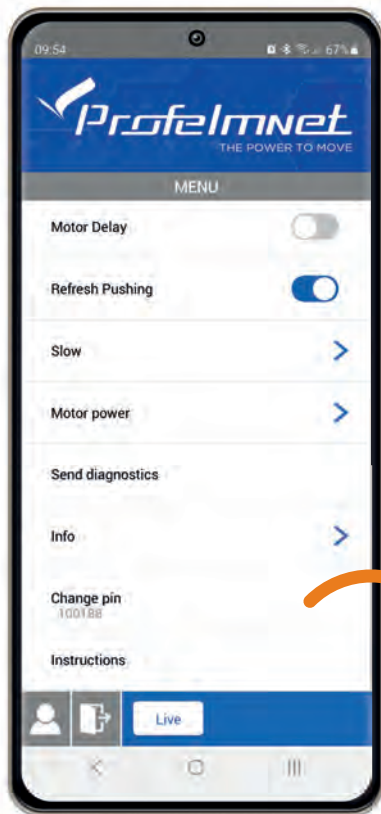

CHANGE PIN

SELECTION CONFIRMATION

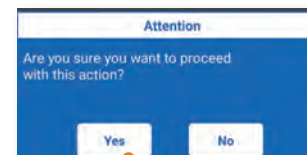



www.profelmnet.com