

**EASY TECH**  **app**

**5033**  
**USER MANUAL**

## SERIES 50

The Series 50 is the complete range of Profelmnet automation systems featuring BLUETOOTH technology. It is combined with the Profelmnet Easy Tech application, available for ANDROID and iOS. Through the Profelmnet Easy Tech application, the technician is able to configure all automation functions using a smartphone, tablet, or computer.

### 5033 – Automation system for 1 motor 230VAC

#### GENERAL INFORMATION

The automation control board has been designed for controlling sliding doors / shutters / residential gates operated by 230VAC motors. It is intended for use in residential and commercial installations and must be installed by personnel with basic technical knowledge of electrical systems and automation. This device is an automation component and not a complete machine. The final installation of the door or gate must comply with the applicable safety requirements of the door itself. The product complies with the essential requirements for safety, electromagnetic compatibility, and radio equipment of the relevant European Directives.

#### IMPORTANT SAFETY INFORMATION

- The product must be used and installed only in applications for which it was designed
- Keep these instructions for future reference
- Ensure proper grounding is present
- Before carrying out any wiring or programming, disconnect the power supply
- A 6A / 30mA residual current device (RCD) must be used for power supply
- Do not modify or alter any part of the automation system without

prior consultation with Profelmnet

- Do not allow children or pets near the door while it is in operation
- Keep remote controls out of reach of children to prevent accidental operation
- Installation, maintenance, or repair must be carried out by qualified personnel
- Installation of a safety contact for pedestrian protection is mandatory
- Profelmnet, as the manufacturer, reserves the right to modify the product without prior notice
- Any use not described in these instructions is not recommended
- Installation must be carried out with the power supply disconnected

The device must be used only with active safety devices (e.g. photocells or safety edge) to ensure safe operation. After installation, a complete travel test of the door must be performed. Do not operate the door if people, animals, or objects are present in its path

Before use, the installer must ensure that the door moves freely and without mechanical resistance

#### TECHNICAL SPECIFICATIONS

- Operating voltage: 230VAC 50Hz
- Motor output: 230VAC
- Accessories output: 12–24VAC
- Operating temperature: –20°C to +60°C
- Remote control receiver: Rolling code or Fixed code, depending on the model

#### MANDATORY USE OF PHOTOCELLS

For safe operation of the door, the installation of photocells is mandatory

in every new automation installation.

Operating the door without active safety devices makes the system non-compliant with EN 12453 safety requirements.

The door must not operate without an active photocell.

If the photocells are not connected or are not operational, the system must be used only in manual mode.

### OPERATIONAL TEST PROCEDURE

After installation:

1. Verify that the door moves smoothly without obstruction
2. Check correct operation of the photocells
3. Check the limit switches
4. Perform 5 complete opening/closing cycles
5. Ensure that the manual release mechanism operates correctly

### CE DECLARATION OF CONFORMITY



According to Directive 2006/42/EC (Machinery Directive), the manufacturer: L. PSARROS & SIA OE declares that the following product: 5033 – Automation system for 1 motor 230VAC is an automation component and not a complete machine, and complies with the requirements of the following European Directives: 2014/53/EU – Radio Equipment Directive (RED) - 2014/30/EU – Electromagnetic Compatibility Directive (EMC). The product complies with the essential requirements and relevant provisions applicable to it. The integrated Bluetooth radio module complies with Directive 2014/53/EU (RED) and operates in the 2.4GHz frequency band in accordance with European regulations. Final installation and commissioning are permitted only when the complete system complies with Directive 2006/42/EC.

### INSTALLATION RESPONSIBILITY

Profelmnet bears no responsibility for the final installation of the door or for improper or incomplete use of the product.

Correct installation and adjustment of safety devices (photocells, safety edge, motor force settings) are the responsibility of the installer or the individual completing the installation.

Operating the door without installed safety devices is prohibited and may cause injury or damage.

Profelmnet supplies only the automation equipment and is not the manufacturer of the final door or gate.

### MANUFACTURER CONTACT DETAILS:

PROFELMNET L. PSARROS & SIA OE

#### Address:

11 Proedrou Drakaki Street  
17341 Agios Dimitrios, Athens, Greece

#### Phone:

+30 210 9850244  
+30 697 4894108 (Technical Support)

#### Email:

info@profelmnet.com

# 5033

Wiring diagram for automation of sliding and swing gate, roller shutter, barrier 230VAC

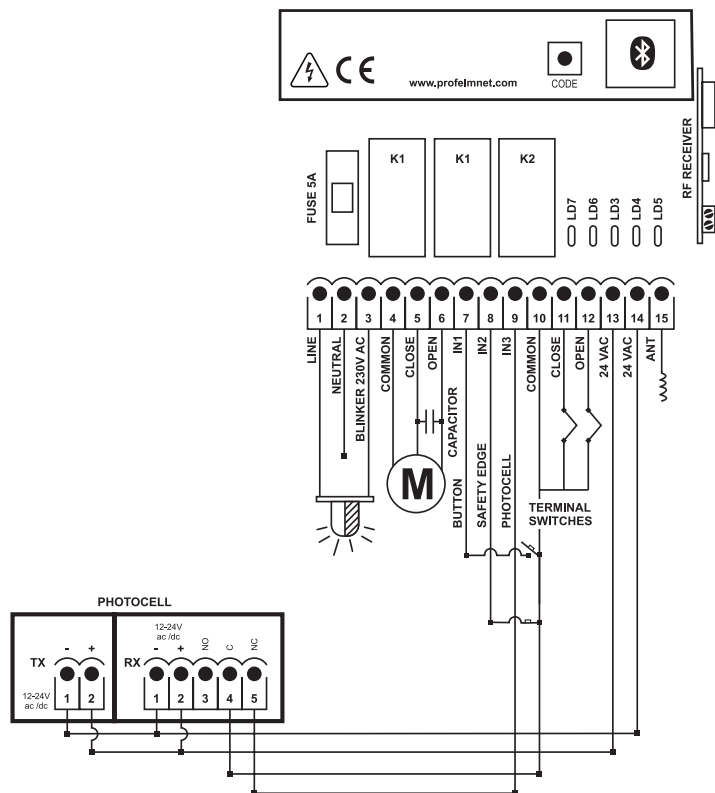

## TECHNICAL CHARACTERISTICS

Power supply	230VAC /50 Hz
Max. Motor power	1200W
Box dimensions	9.5cm X 4.5cm X 13cm
Control board dimensions	7.5cm X 3cm X 10.5cm
Fuse 230VAC	5A
Fuse 24VAC	150mA
Blinker light power supply	230VAC
Photocell power supply	24VAC/100 mA
Remotes memory	removable memory up to 300 remotes
Temperature	-20o C + 60o C

## ELECTRICAL CONNECTIONS

1	Line
2	Neutral
1+3	Blinker 230VAC
4	Motor common
5	Motor close
6	Motor open
7+10	Button - NO
8+10	Safety edge - N.C
9+10	Photocell - N.C
10	Terminal switches & accessories common
11+10	Close terminal switch - N.C
12+10	Open terminal switch - N.C
13+14	Accessories power supply 24VAC
15	Antenna

ACTIVATE INTERNET AND BLUETOOTH  OF YOUR DEVICE  
DOWNLOAD THE PROFELMNET EASY TECH APPLICATION

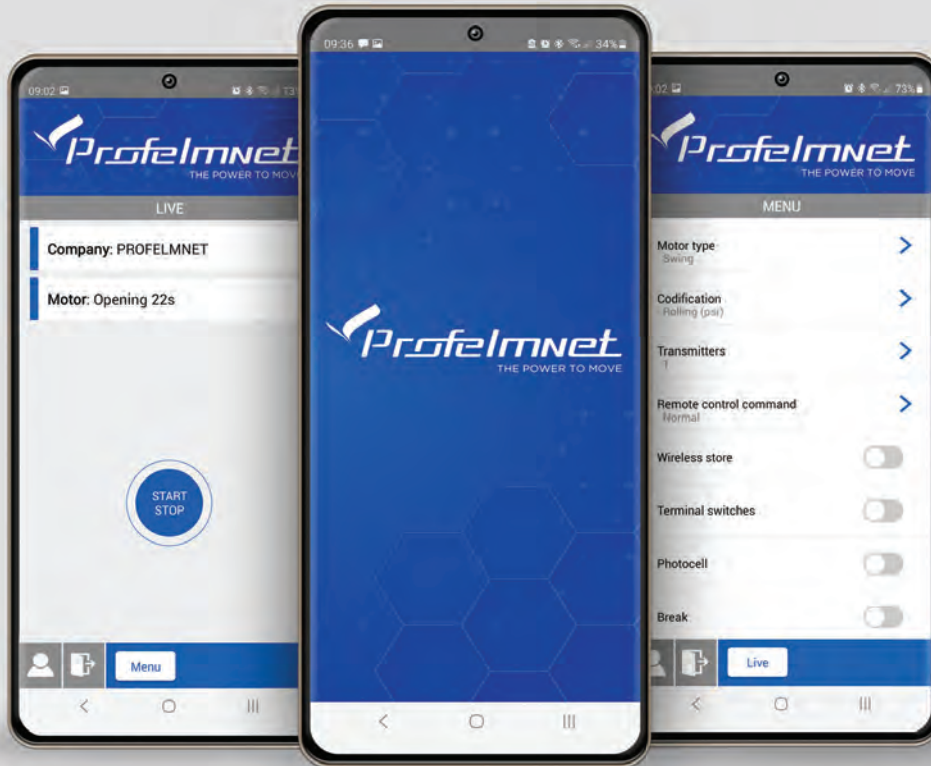

ProfelmNet  
Easy Tech



## REGISTER

### FOLLOW THE STEPS TO REGISTER

- 1 Choose the language
- 2 Press Register & fill in your personal data
- 3 Scan QR code. Find the QR code on the board & scan it
- 4 Press sign up to finish

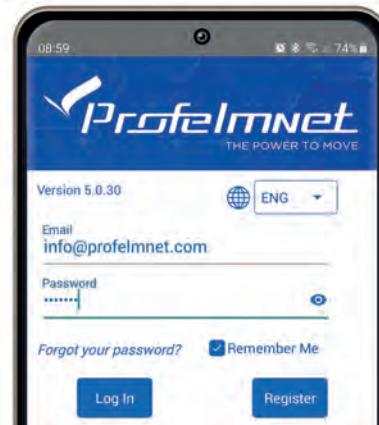
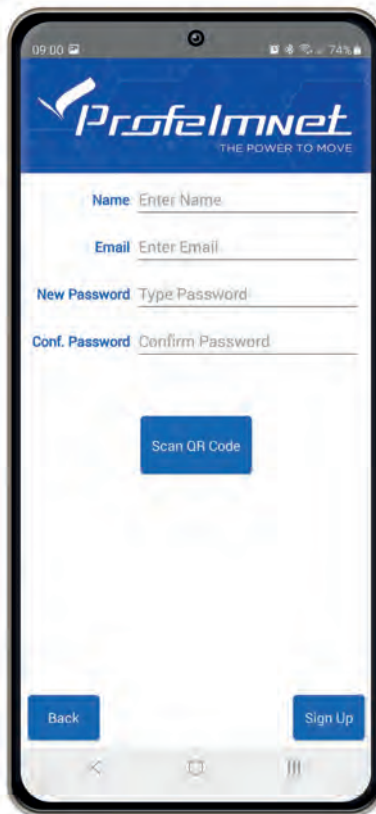
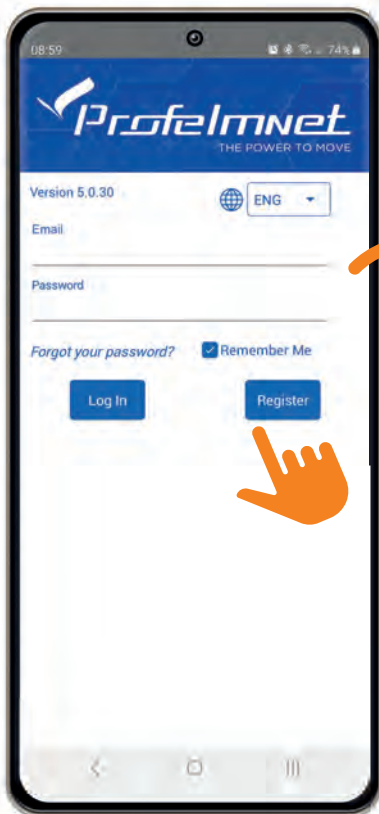

## CONNECTION with the board

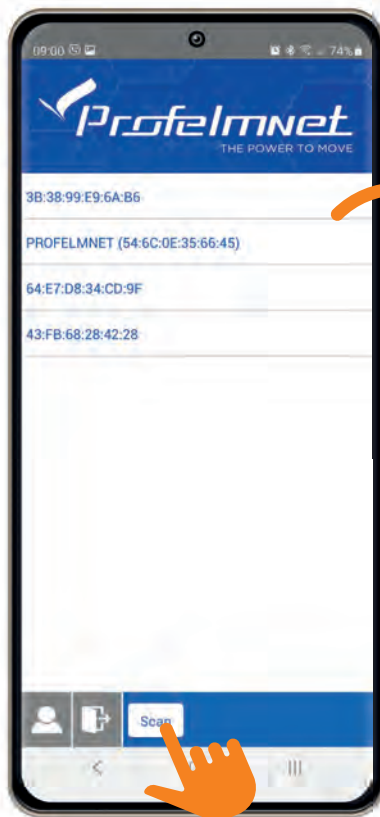

- 1 Press scan to find the **PROFELMNET** device
- 2 Choose the PROFELMNET device
- 3 Type the **6 Digit PIN**

During the first connection, type 000000 PIN and then type your personal 6-digit PIN.

**i** The PIN code is your personal security number. Without this PIN code, you can not access the board. Avoid using simple easy PIN codes (i.e 111111)



## LIVE SCREEN

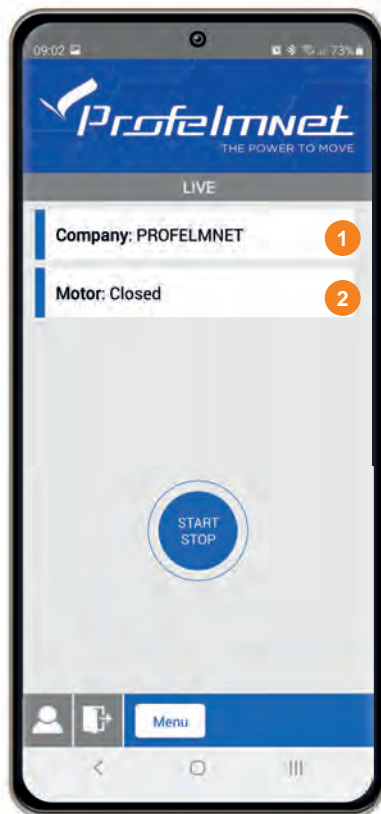

- 1 Company:  
Board Supplier
- 2 Motor:  
Installation Info



**USER PROFILE:**  
Edit your personal data



## SWITCH LIVE SCREEN TO MENU SCREEN

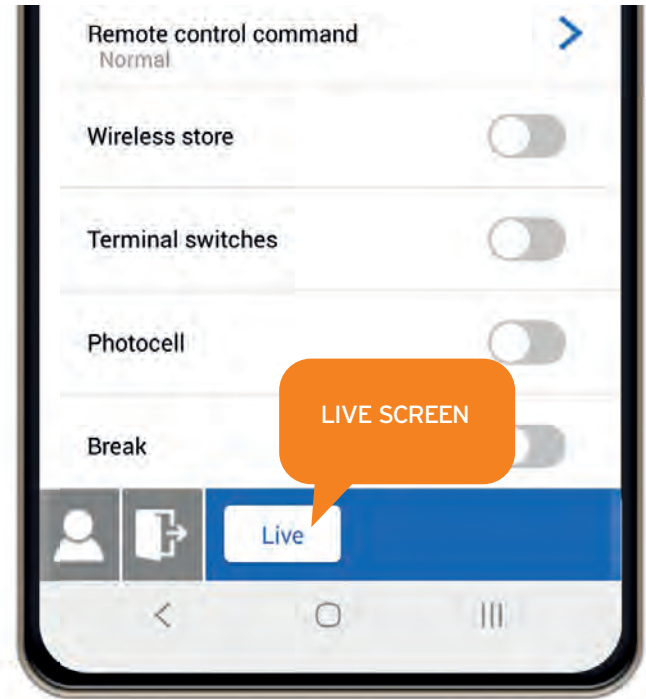
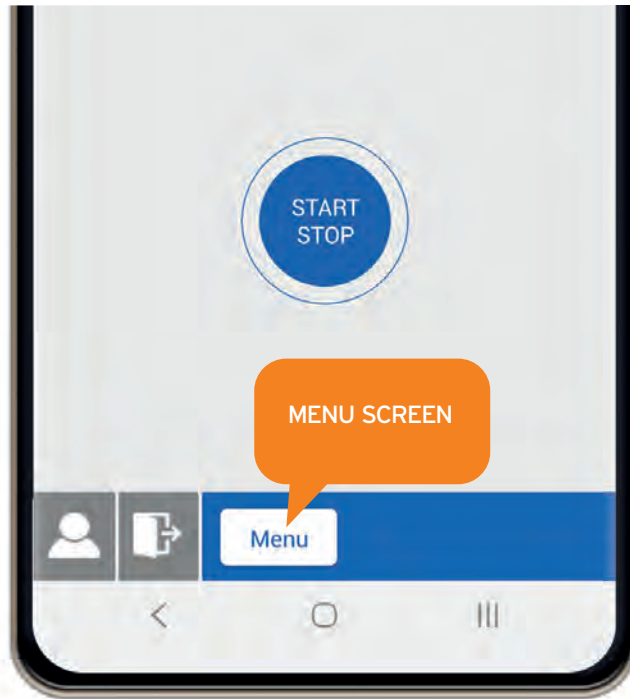

## MENU: Motor Type

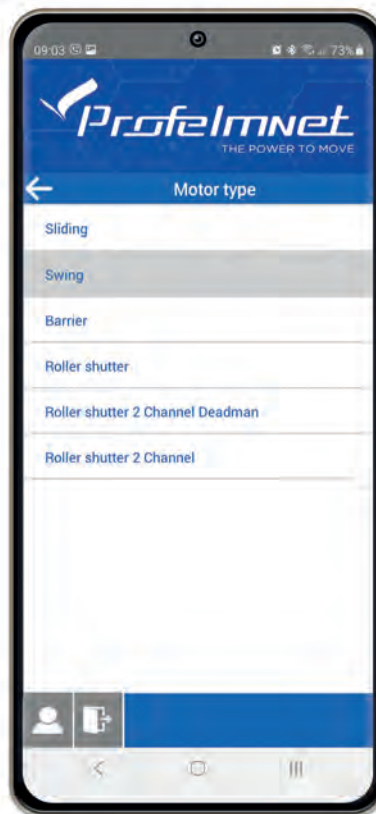
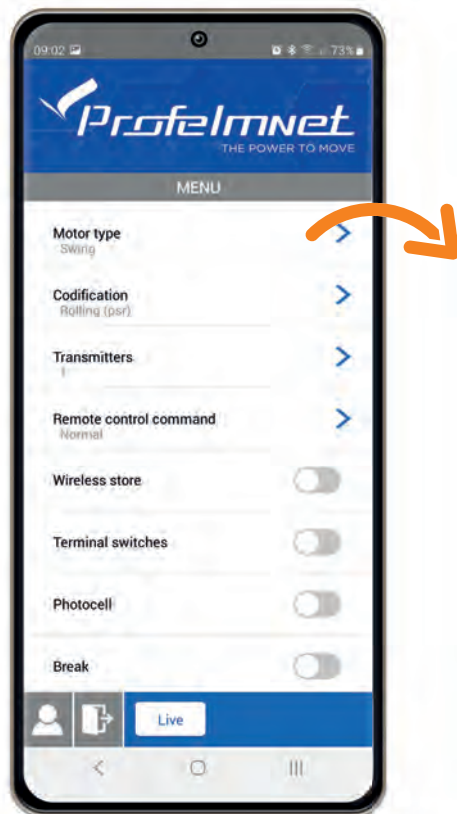

Select based on the installation

SELECTION CONFIRMATION

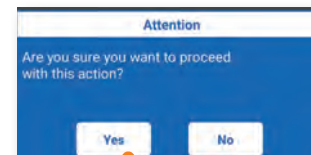

## MENU: Codification

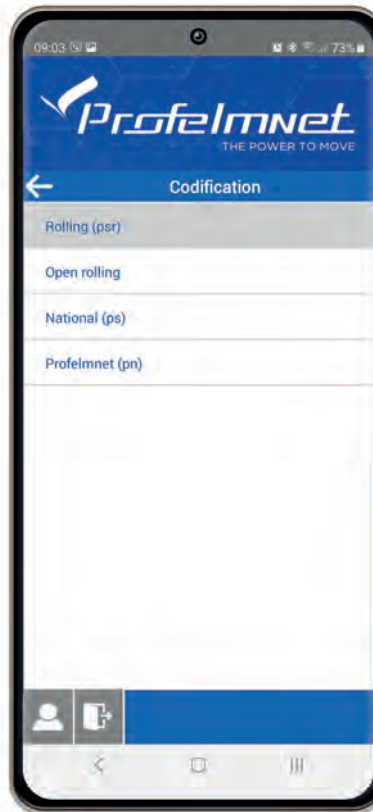
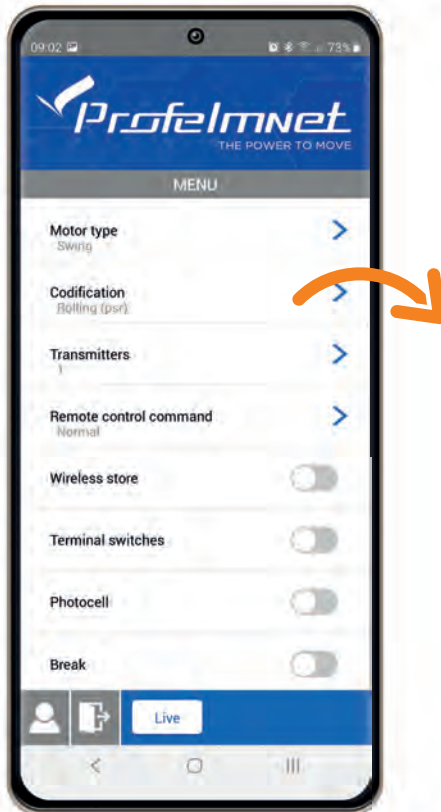

Codification: Select based on the installation's transmitters

## MENU: Transmitters

FOR SLIDING - SWING - BARRIER - ROLLER SHUTTER

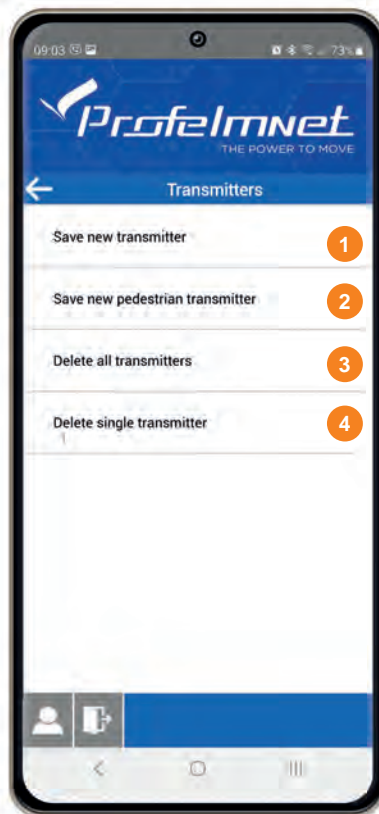
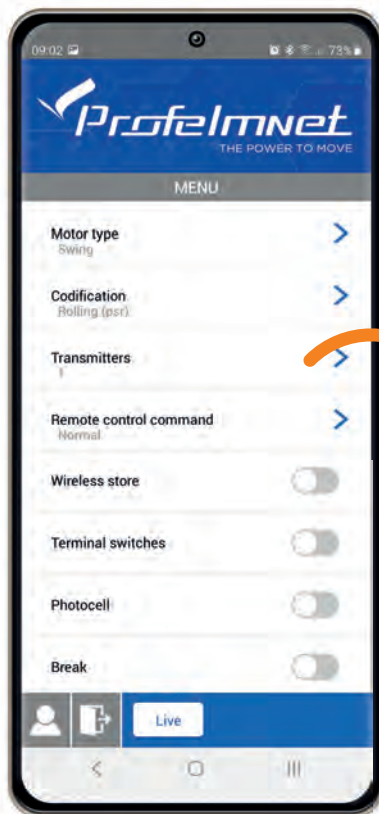

- 1 Save new transmitter:**  
Press the transmitter button you want to save
- 2 Save new pedestrian transmitter:**  
Press the transmitter button you want to save as pedestrian
- 3 Delete all transmitters:**  
YES/NO
- 4 Delete single transmitter:**  
Choose the number of transmitter to DELETE.



### USER NUMBER:

The number displayed on the main screen of the application, LIVE screen, every time each remote control is activated.

## MENU: Transmitters

ROLLER SHUTTERS 2 CHANNELS DEADMAN  
ROLLER SHUTTERS 2 CHANNELS

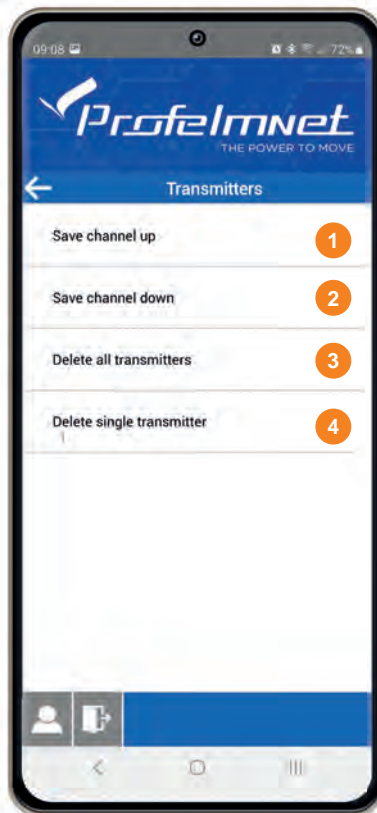
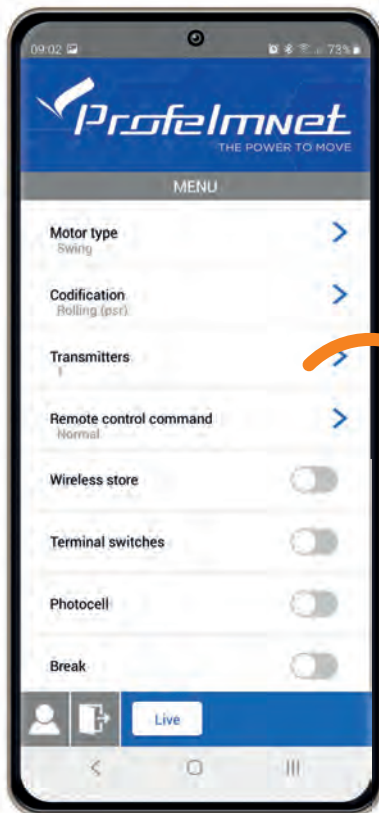

- 1 **Save channels up:**  
Press the transmitter button you want to save for UP direction
- 2 **Save channel down:**  
Press the transmitter button you want to save for DOWN direction
- 3 **Delete all transmitters: YES/NO**
- 4 **Delete single transmitter:**  
Choose the number of transmitter to DELETE.

### SELECTION CONFIRMATION

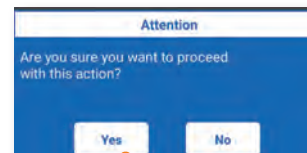

## MENU: Remote control Command

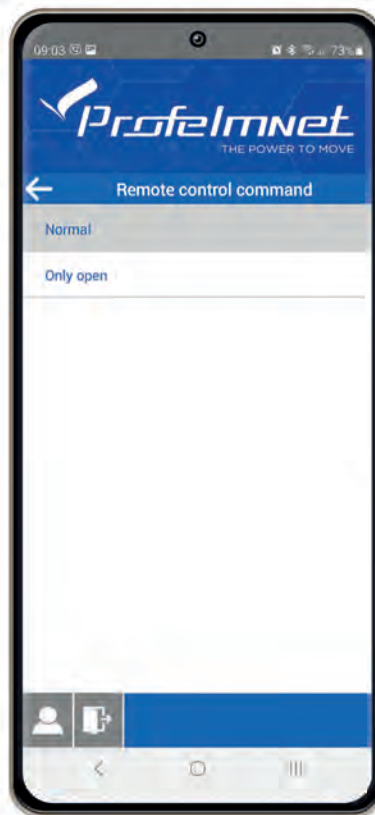
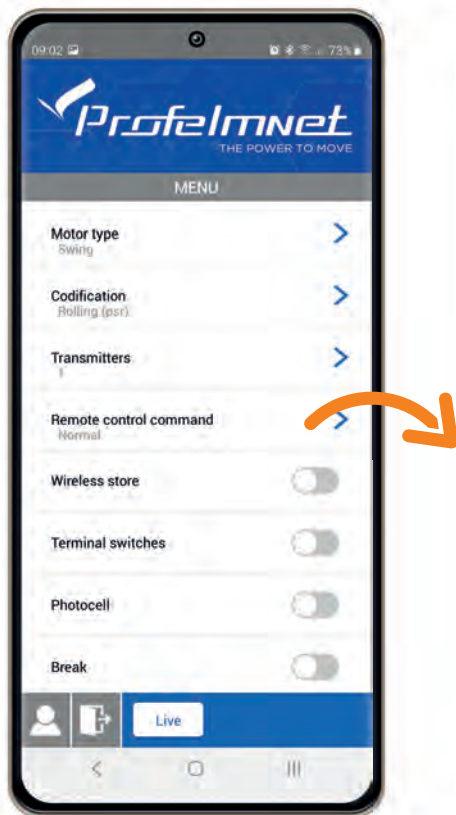

Remote control command

Normal:  
START-STOP-CLOSE

Only Open

## MENU: Settings ON/OFF

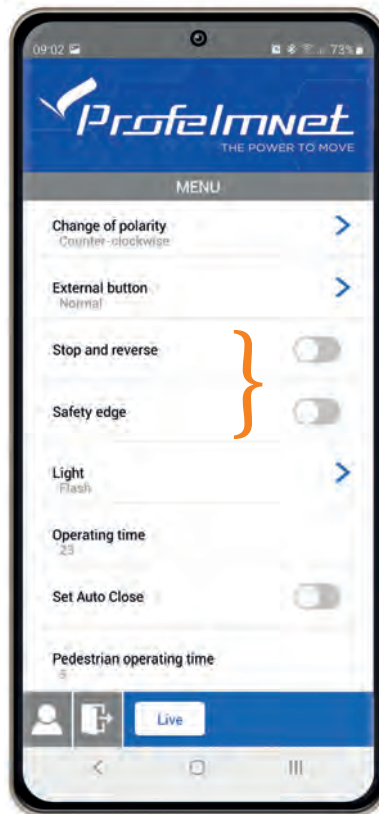
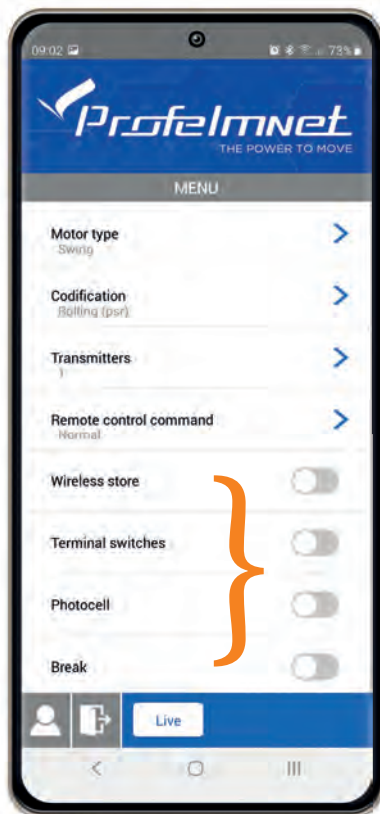

Wireless store  
TerminalSwitches  
Photocell  
Brake  
Stop and Reverse  
Safety Edge

OFF ☐ ON ☒



### ADD NEW REMOTE CONTROLS WIRELESS:

The motor is fully closed or open. Press a working transmitter button (already in memory) to start the motor working and hold it pressed until the motor stops. When it stops, leave it and press the new transmitter button immediately. The new transmitter is saved. Repeat steps to program more transmitters remotely. When the memory is full (300 transmitters) you cannot add more new transmitters.



## MENU: Change of polarity

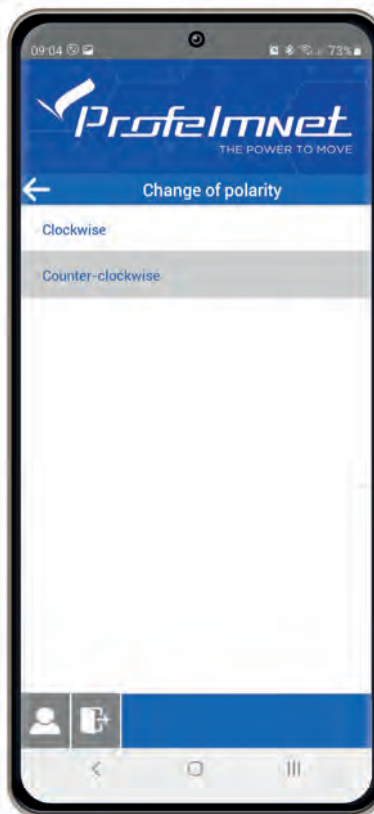
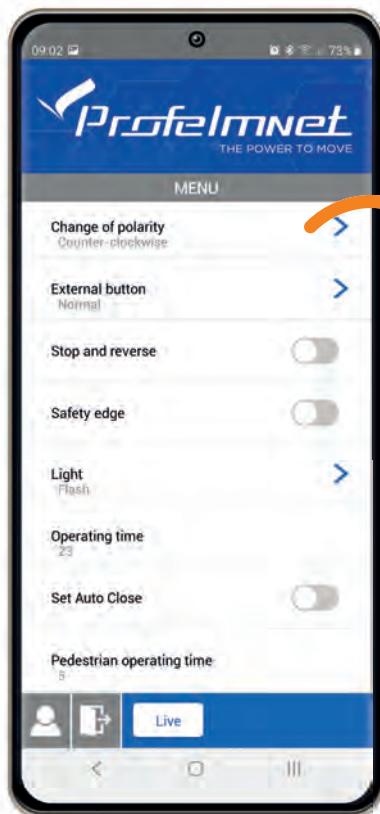

Change the motor and terminal switches polarity based on the installation

### SELECTION CONFIRMATION

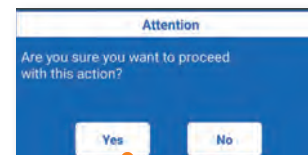

## MENU: External Button

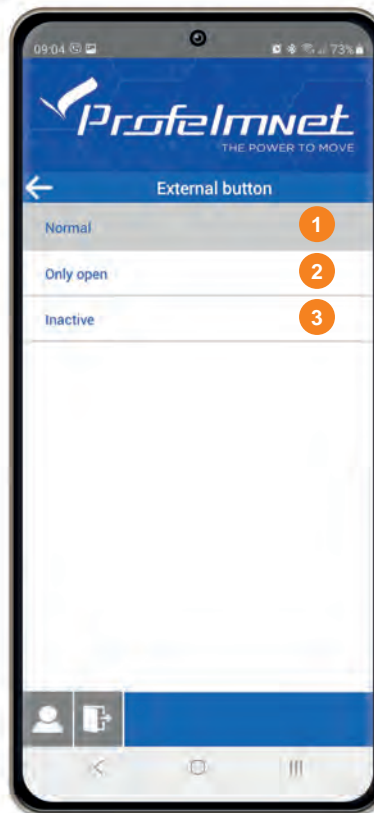
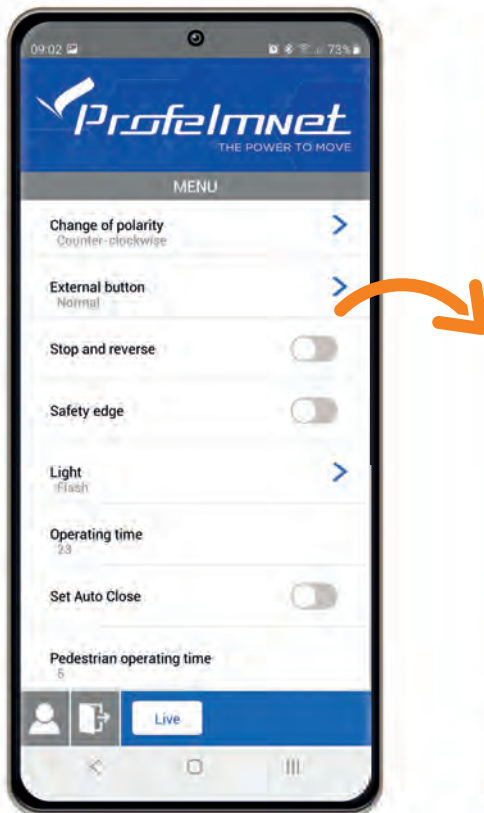

External Button: Select based on the installation

- 1 NORMAL
- 2 ONLY OPEN
- 3 INACTIVE

## MENU: Flash

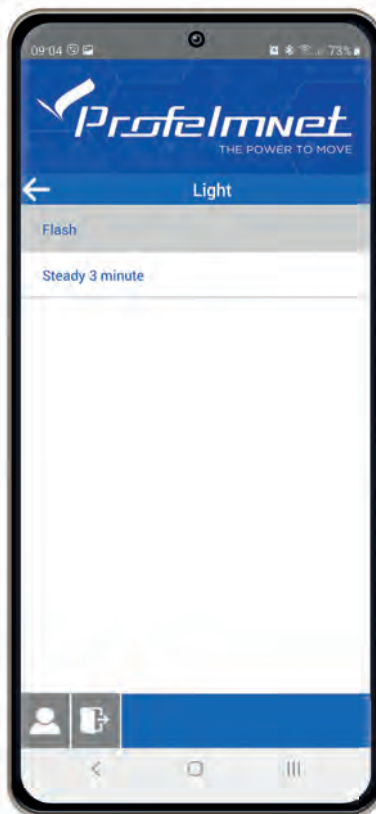
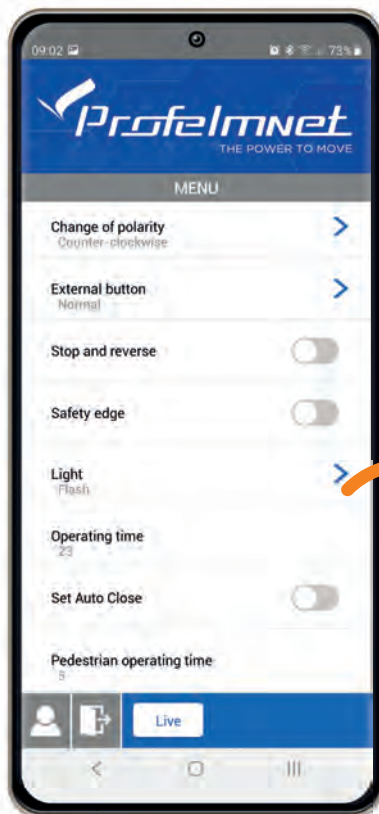

**FLASH:** The light is flashing during the cycle of the motor.

**LIGHT STEADY 3 MINUTES:** The light is steady for 3 minutes after the last command.

### SELECTION CONFIRMATION

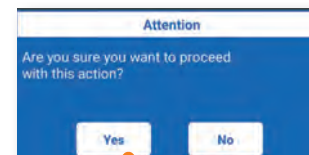

## MENU: Operating Time

Follow the application steps

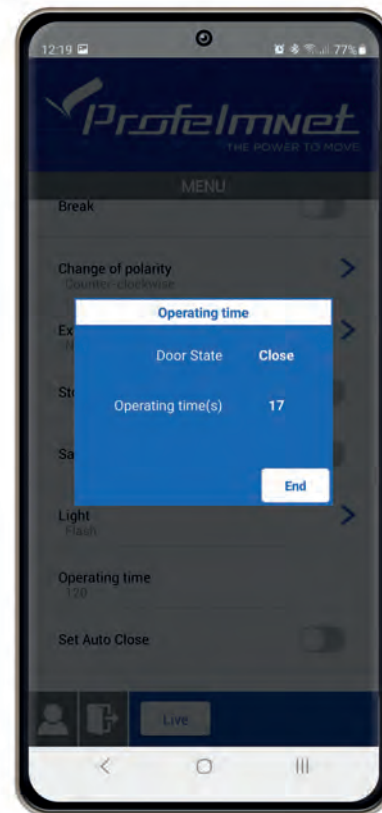
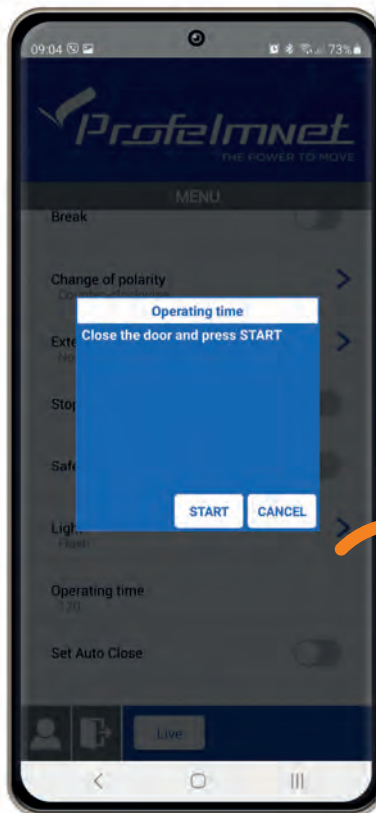
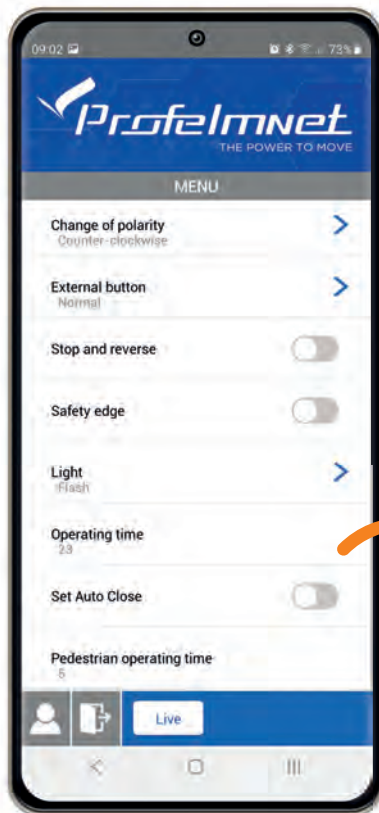

## MENU: Set auto - close

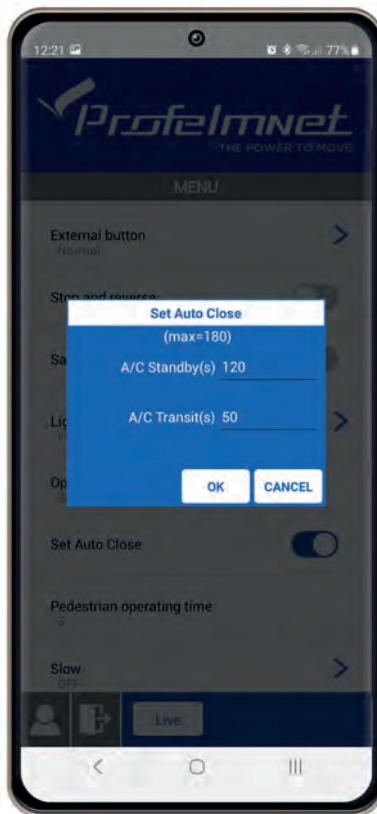
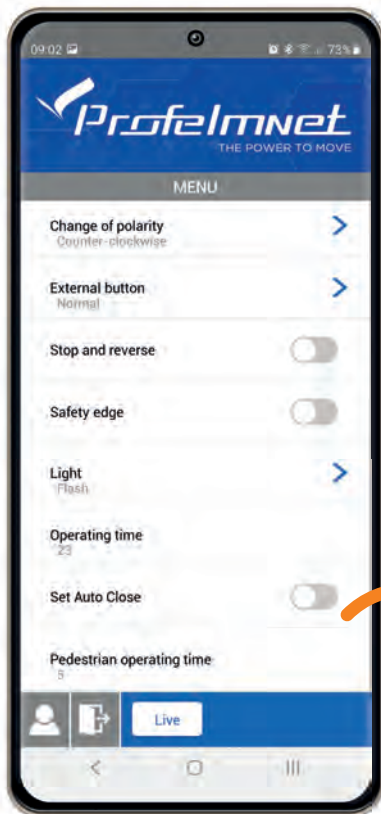

- **Auto-Close Stand-by:**

*The time when the gate is open and the photocell is not activated*

- **Auto close Transit:**

*The time when gate is open after the photocell is activated*



### SET TIME:

*Set time on each field in seconds*

*If you want to edit the time, you need to disable the AUTO-CLOSE and re enable it*

OFF ☐ ON ☒

## MENU: Pedestrian operating time

Follow the application steps

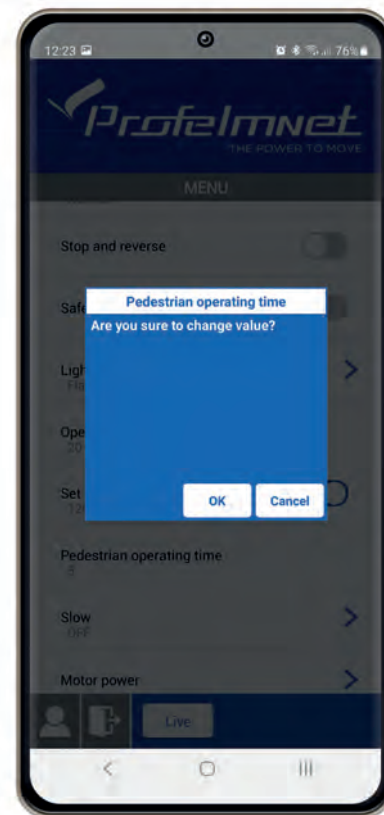
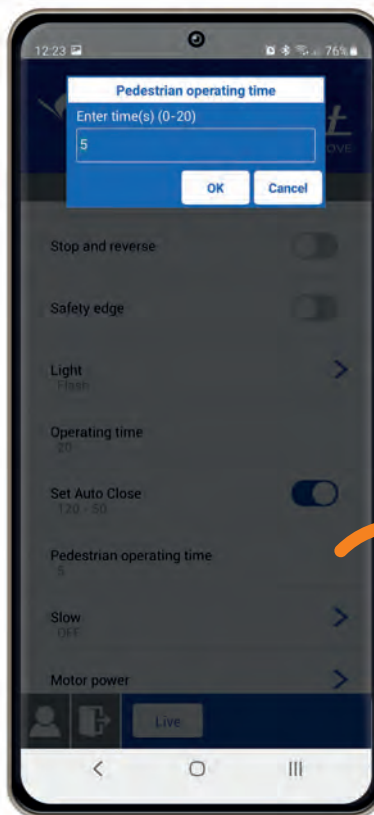
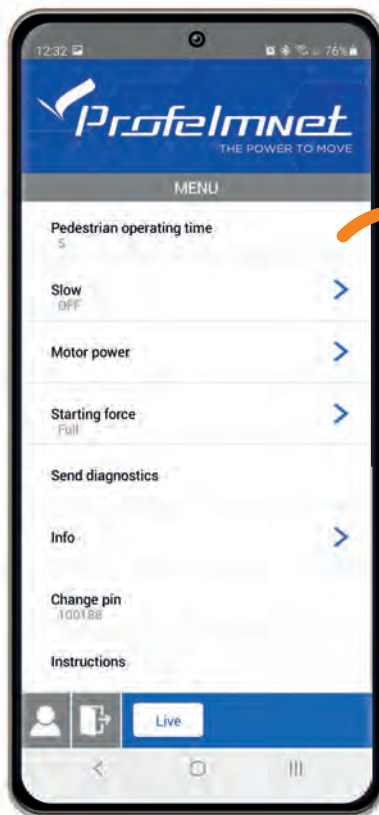

## MENU: Deceleration

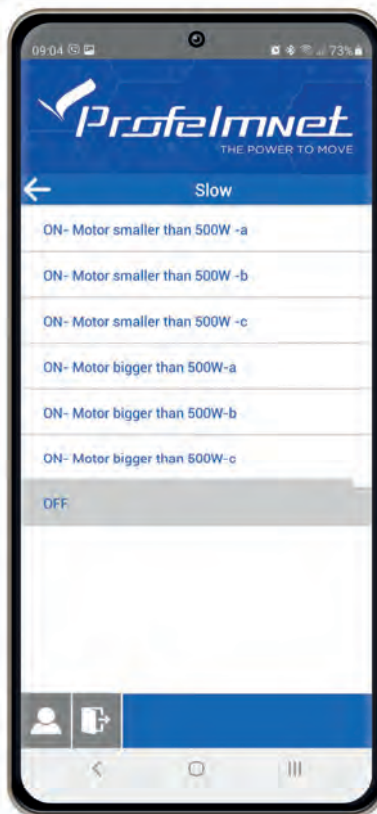
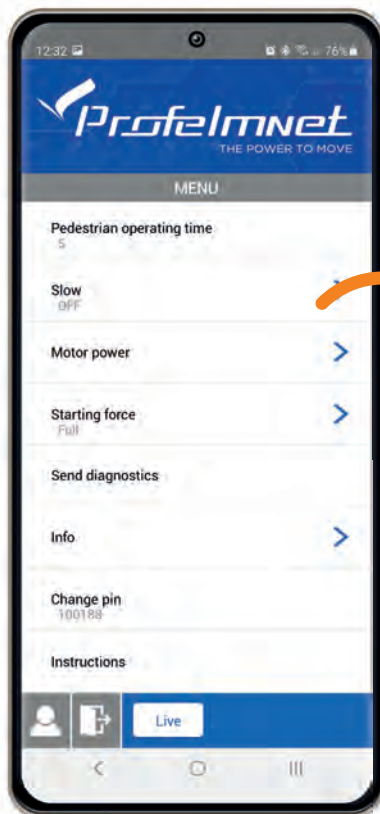

### DECELERATION

Select based on the installation



#### *Recommended Factory Settings:*

- 1. Motor less than 500 watt:  
Choice A*
- 2. Motor more than 500 watt:  
Choice A*



## MENU: Motor Power

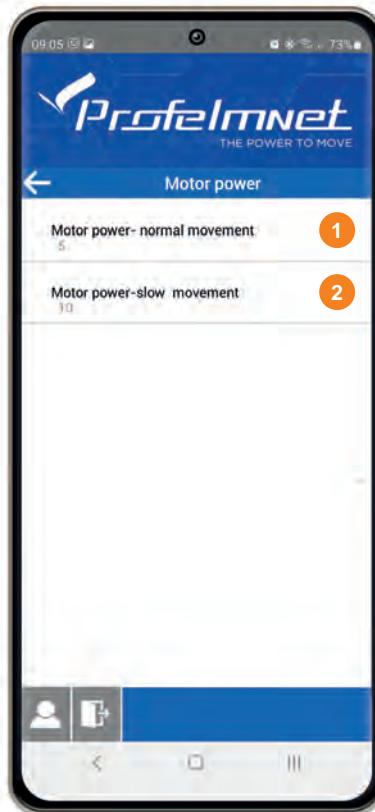
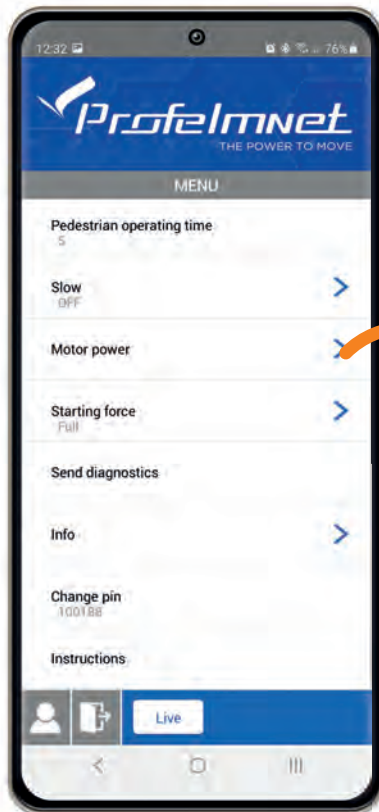

- 1 Motor power - normal movement  
Enter value
- 2 Motor power - slow movement  
Enter value

ENTER VALUE

Motor power- normal movement

Enter value (1-10)

5

OK Cancel



## MENU: Starting Force

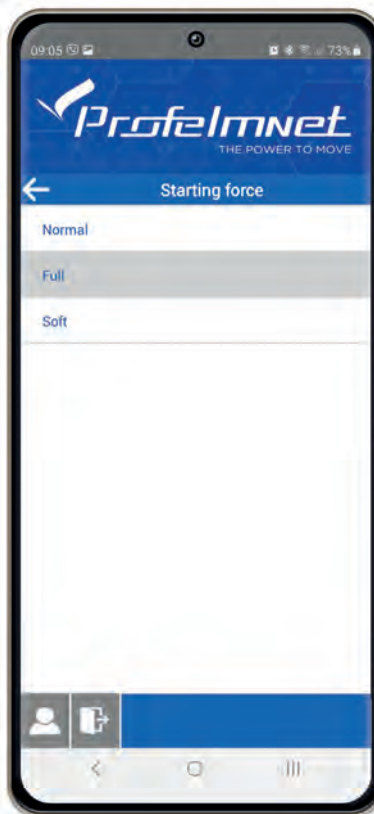
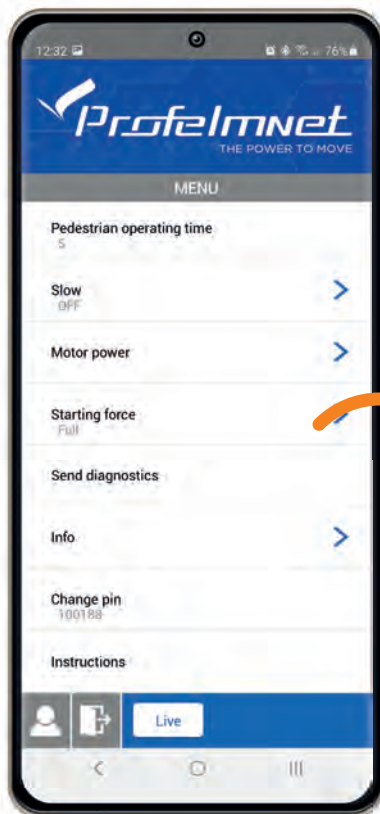

Select based on  
the installation

## MENU: Send Diagnostics

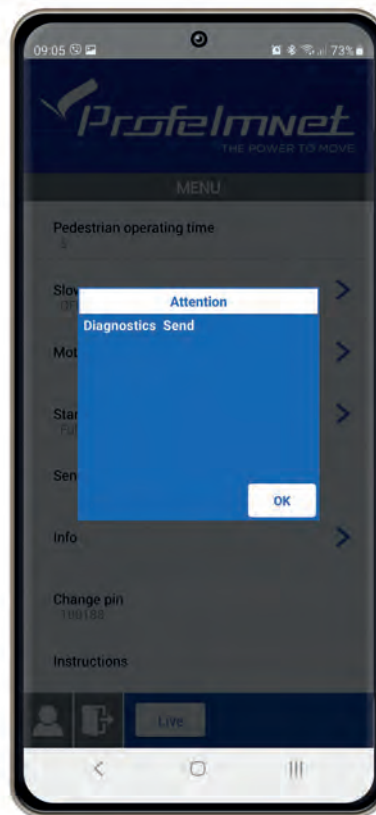
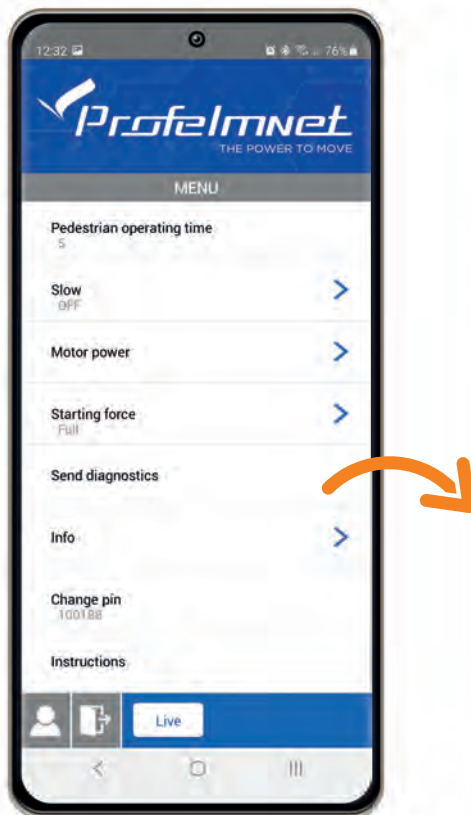

In case of technical support, send diagnostics to the Profelmnet technician

## MENU: Info

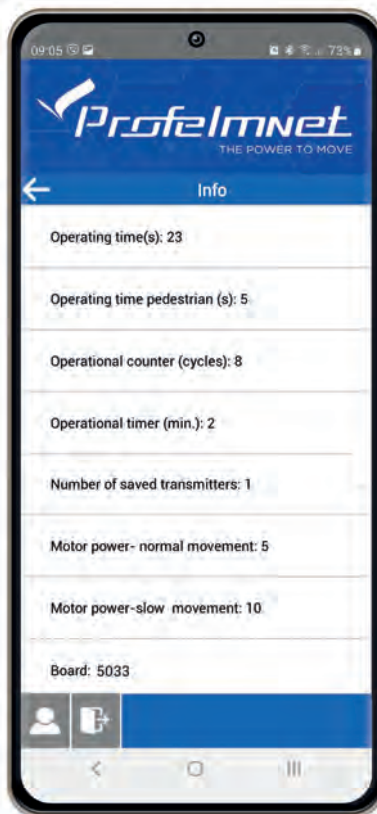
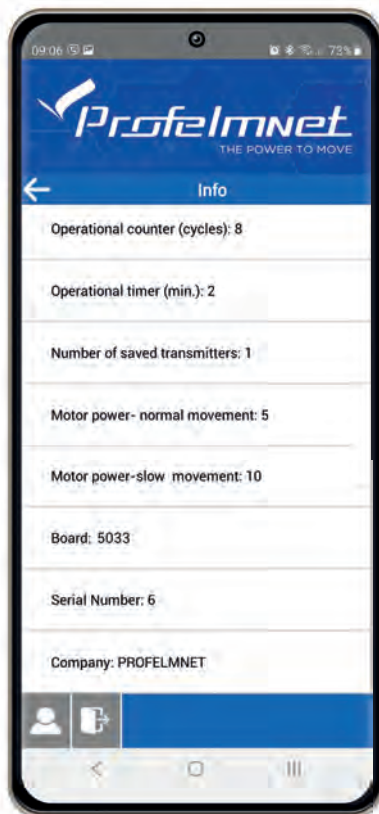

All information of the board

## MENU: Change PIN

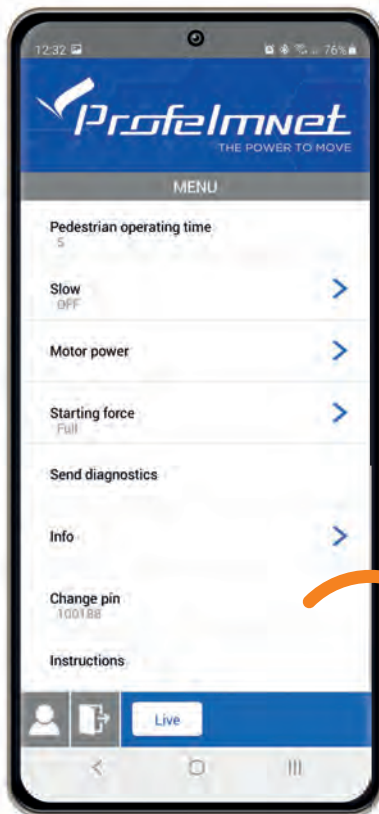

CHANGE PIN

SELECTION CONFIRMATION

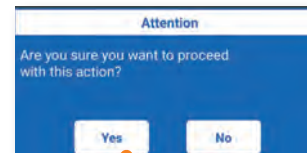

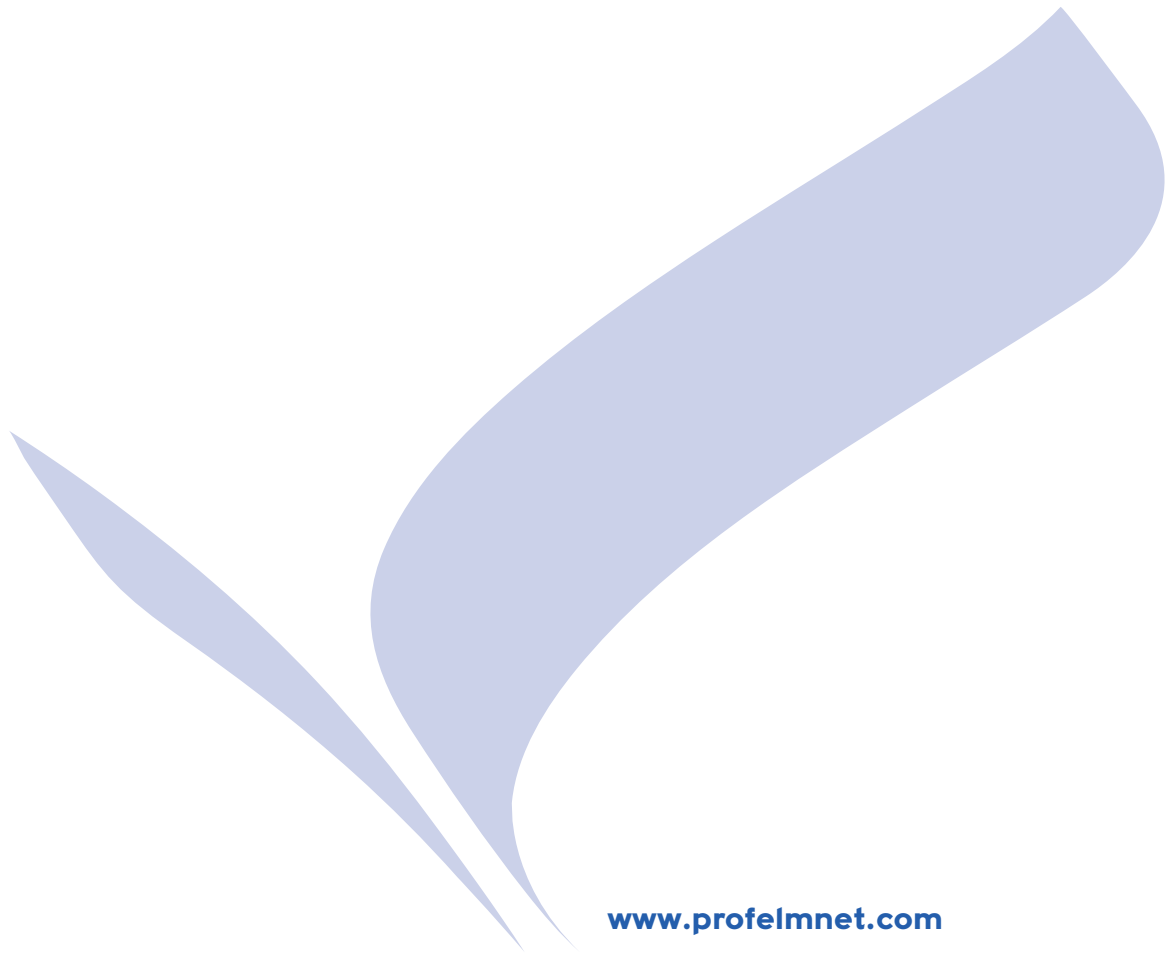

[www.profelmnet.com](http://www.profelmnet.com)